

**document packet contents for "Albany Road" portfolio**

- 1. Massachusetts documents: the road proposed and surveyed in 1739**
- 2. Massachusetts documents: Ephraim Williams and two new townships**
- 3. Massachusetts documents: the road between Williamstown and Charlemont**
- 4. Massachusetts documents: the road between Charlemont and Deerfield**
- 5. British intelligence document**
- 6. Nelson Hull booklet excerpt**
- 7. Bleecker map and road survey**
- 8. Cumberland County road legislation**
- 9. Sauthier map**
- 10. Medcalfe map**
- 11. Middletown map and Bishop map**
- 12. Greene survey and Eastern Turnpike map**
- 13. East Manor survey documents**
- 14. East Manor map and Burr map**
- 15. Beers/Lake map and Beers Atlas (Poestenkill)**
- 16. Beers/Lake map and Beers Atlas (Berlin)**
- 17. David Costello maps (overview and sample section)**





(2)

In conjunction with the settlement of West Hoosuck (Williamstown), the Massachusetts legislature granted land to Ephraim Williams, and on Dec. 12, 1752, required that he "always keep an open Way two Rods wide on the northerly side of Massachusetts-Fort, leading towards Albany."

arising by said Sale, be applied to the Payment of the Debts in the Petition mentioned. Sent up for Concurrence.

An engross'd Bill Intituled *An Act for preventing Damage by Horses going at large.*

Read and Resolved, That the Bill pass to be enacted.

Petition of  
Capt. James  
Stevens &c.

A Petition of Capt. James Stevens of Andover, and sundry others of the County of Essex and Middlesex, who (most of them) were in the Expedition against Cape Breton, praying the Grant of a Township out of the unappropriated Lands of the Province, under such Restrictions and Limitations as this Court shall order, for their Services mentioned.

Read and committed to Col. Richards, Mr. Tyng, Capt. Livermore, Major Lawrence, and Col. Porter, to consider and report thereon.

Engross'd Bill.

The Bill Intituled *An Act to incorporate William Starkey and others therein named into a Society by the Name of the Marine-Society.*

Read a third Time and pass'd to be engross'd.

Sent up for Concurrence by Mr. Vassall, Capt. Elijah Williams, Capt. Sole, Col. Buckminster, and Major Cutt.

Monitor.

Ordered, That Mr. Cushing be a Monitor of the House, in the Room of Mr. Cogswell, during his Absence.

Report on  
Capt. Williams  
Plan.

The Committee to whom was refer'd the Consideration of the Plan of Capt. Ephraim Williams, reported thereon according to Order.

Read and accepted, and thereupon Ordered, That the said Plan be accepted, and that the Land therein delineated and described be and hereby is confirmed to the said Capt. Ephraim Williams, his Heirs and Assigns forever, provided the Land exceeds not the Quantity of the Grant, and does not interfere with any former Grant, provided also that the Grantee always keeps an open Way two Rods wide on the northerly Side of Massachusetts-Fort, leading towards Albany.

Sent up for Concurrence.

Petition of  
Capt. John  
Clark.

A Petition of Capt. John Clark of Salem, Captain of His Majesty's Fort within that Town, praying he and his Company may be allowed Pay for their Service, from the Year 1746, to the Year 1751, for the Reasons mentioned.

Read and Ordered, That this Petition be dismiss'd.

Bills engross'd  
and enacted.

A Bill Intituled *An Act to prevent the breaking or damnifying of Lamps set up in or near Streets for enlightning the same.*

Read and pass'd a Concurrence with the honourable Board in the Engrossment.

An engross'd Bill Intituled *An Act in Addition to an Act passed the 13th Year of His present Majesty's Reign, Intituled, An Act further to exempt Persons, commonly called Anabaptists, within this Province, from being taxed for and towards the Support of Ministers.*

Read and Resolved, That the Bill pass to be enacted.

Grant to Moses  
Desbon.

Ordered, That the Sum of six Pounds thirteen Shillings and four Pence, be allowed and paid out of the publick Treasury to Moses Desbon, in Consideration of the Arms of the Colony, which he has carv'd, and put up in the House of Representatives.

Sent up for Concurrence.

Then the House adjourn'd 'till to Morrow Morning ten o'Clock.

De recuti

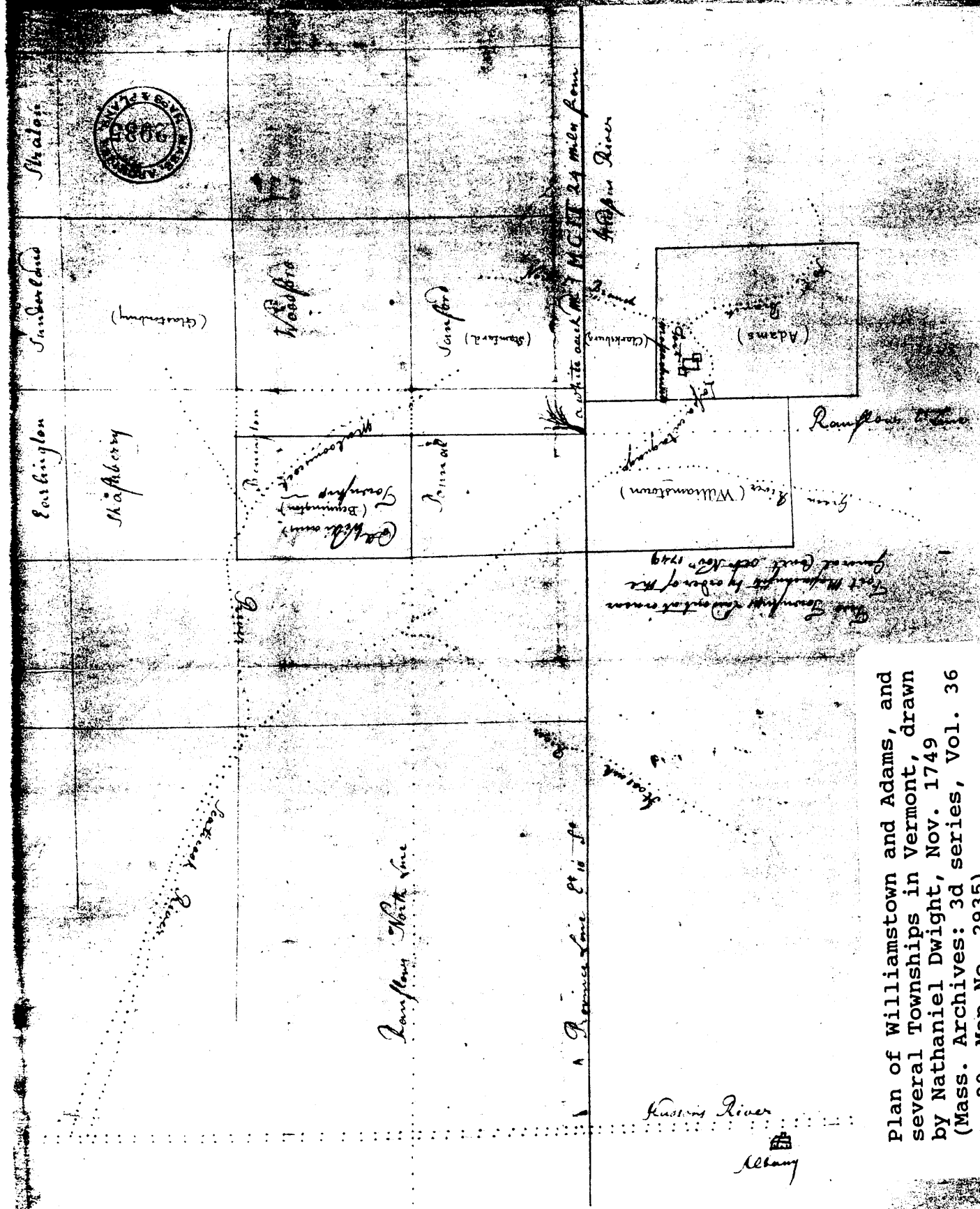

Plan of Williamstown and Adams, and several Townships in Vermont, drawn by Nathaniel Dwight, Nov. 1749 (Mass. Archives: 3d series, Vol. 36 p. 20, Map No. 2935)

Map showing 200 acre tract granted to Ephraim Williams, dated April 19, 1751. The "Albany Road" had not yet been built, but Fort Massachusetts & the Hoosic River are shown.

(Mass. State Archives, 3rd series, vol. 46, p. 279, #679)

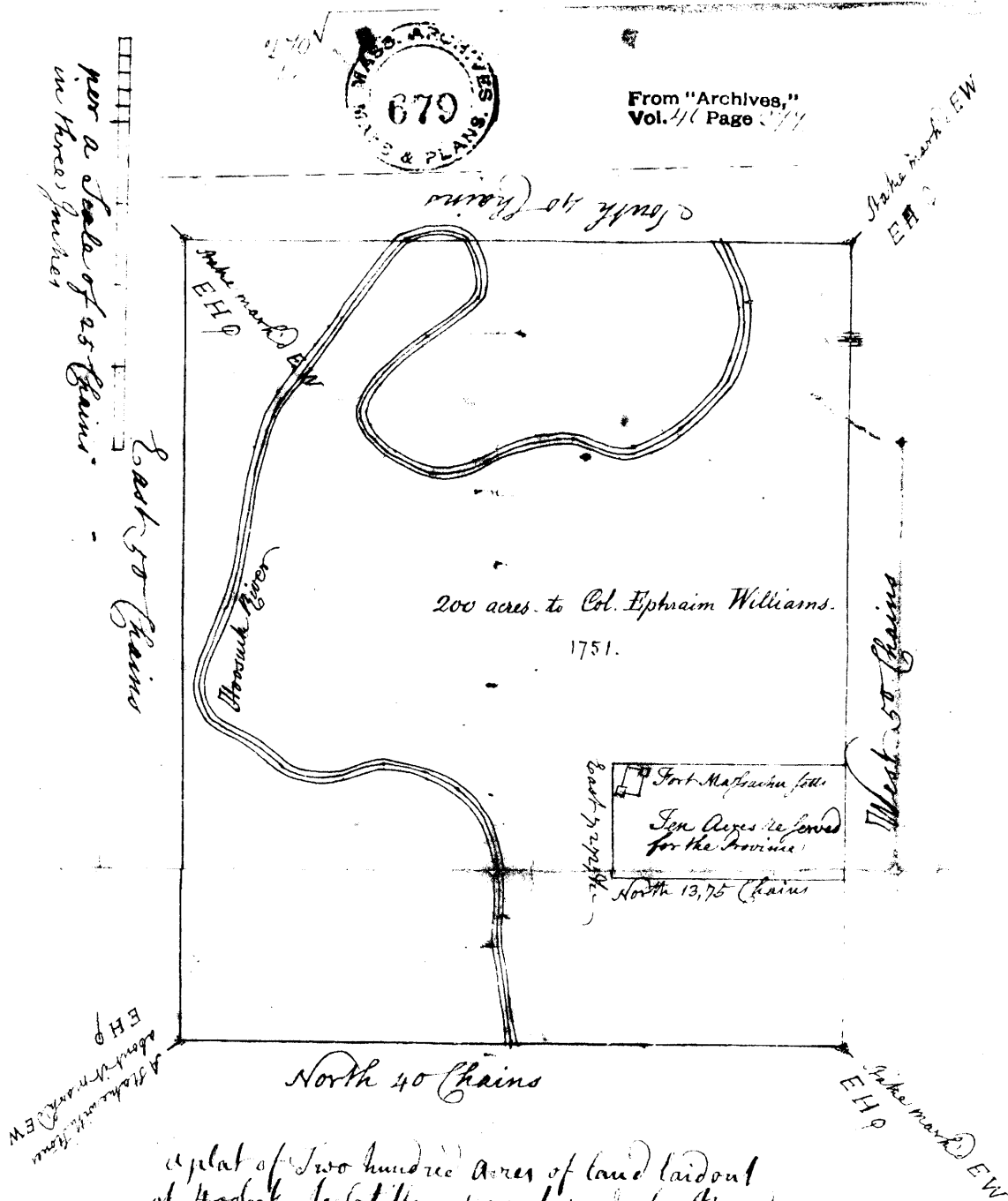

A plat of Two hundred Acres of land laid out at Hadlock to satisfy a grant made by the General Court to Ephraim Williams in which is included ten Acres, reserved for the use of the Province, surveyed by the Deeds of the instrument, instructed by a scale of 25 Chains in three inches, said plat shown to Abraham Baf (Chambers)

Hadlock April 19th 1751—

John Hadlock, Surveyor

Chambers County Oct. 17 1752 - John Hadlock & Abraham Baf appearing made solemn oath that they acted faithfully & impartially in surveying & laying out the above land as described in the above plat.

[illegible]

Twenty Years  
Ways and Means

way two Rods wide on the North side of track.

Chas. H. Scott, leading towards all hands and the

I am extremely sorry that I cannot give you  
large amount of money for said farm & house,  
as we feel that we should have the full  
amount.

(3)

123

To his Excellency James Bowdoin Esq  
 Genl Gov in Chief &c  
 To the Honble his Majesty's Council & House  
 of Representatives in Genl Court, I sheweth

That Samuel Rice Humbly sheweth  
 That there is a very Great Necessity of a Highway  
 being made up Hoosuck Mountain to accommodate  
 the Public for it is very Dangerous passing the road that  
 is at Present Several Cattle have lost their  
 lives &c Petitioner has found a much better place for  
 a road and as there is a long tract of land lying near  
 Deerfield containing about 200 acres  
 he humbly begs your Excellency & Hon<sup>ty</sup> will  
 take into consideration & make your Petitioner  
 the owner of said tract of land your Petitioner being  
 as yet a minor make said road up said Hoosuck Mountain  
 for a road with a view of And if Petitioner as  
 your Honor shall ever say Saml Rice

of the Court of Sessions June 12<sup>th</sup> 1764  
 The Quantity of Two hundred acres of unappropriated  
 land in the Province in County of Berkshire be  
 is granted to the petitioner Samuel Rice his heirs &c  
 upon condition that he or they do in one  
 year from this time make a good Road from Charlemont  
 to Hoosuck Mountain & return a plan of said Road  
 to this Court for Confirmation as also a Certificate  
 of the Surveyors of the County of Berkshire of his or  
 their having faithfully & lawfully performed the aforesaid  
 condition  
 Sent up for Confirmation  
 The Clapp Spk<sup>r</sup> of the Town

1764 petition of Samuel Rice for a  
 grant of land just east of "Hoosuck  
 Mountain," in which he offers to  
 construct a new road up the steep  
 mountain from the Deerfield River.  
 (Massachusetts Archives, Vol. 121,  
 p. 423)



to execute a good Deed or Deeds thereof; she observing the Directions of the Law relating to the Sale of Real Estates, and giving sufficient Caution to the Judge of Probate for the County of *Essex* that the interest of one third part of the Money arising by said Sale be for the Support of the Administratrix during her natural Life, and at her decease divided among the legal Heirs; and the other two thirds to be duly applied to the Payment of the just Debts of the deceased, and the overplus, if any there be, shall also be divided among the legal Heirs as the Law directs.

Sent up for Concurrence.

Report on the  
Petition of  
*Samuel Rice*.

The Committee appointed to consider the Petition of *Samuel Rice*, made Report.

Read and accepted, and *Ordered*, That the Quantity of two Hundred Acres of the unappropriated Land of this Province in the County of *Berkshire*, be and hereby is granted to *Samuel Rice*, his Heirs and Assigns forever, upon Condition that he or they do within one Year from this Time, make a good Road from *Charlemont* to the Top of *Hoosuck* Mountain, and return a Plan of said Road and Land to this Court for Confirmation, as also a Certificate from *Elijah Williams*, Esq; and Mr. *Fellows Billing*, of his or their having faithfully and punctually preformed the aforesaid Condition.

Sent up for Concurrence.

The Rights of  
the *British* Colonies,  
&c. read, and re-  
fer'd to a Com-  
mittee.

The Rights of the *British* Colonies in general, and of the Province of the *Massachusetts-Bay* in particular, briefly stated, with some Observations on the Act of the Sixth of *GEORGE* the Second, commonly called the Sugar Act, was agreeable to the Order of the Day read again, and committed to the Gentlemen appointed to consider Mr. Agent *Mauduit's* Letters, and make Report.

Bill read, and  
pass'd to be  
Engros'd.

A Bill Intituled, *An Act to enable* Abigail Little, of *Pembroke*, formerly the Widow of *Isaac Thomas*, late of said *Pembroke*, Gentleman, deceased, to recover of the Children and Heirs of the said *Isaac* certain Sums of Money due from them to the said Abigail for right of Dower in the Real Estate that was the said *Isaac Thomas's*.

Pass'd in Council, *Viz.* In Council, June 11, 1764.

Read

On June 12, 1764, the Massachusetts legislature granted 200 acres of land to Samuel Rice, provided he "make a good road from Charlemont to the Top of Hoosuck Mountain."

Map of Bernardston Grant, 1765,  
now part of Florida, Mass. The map  
shows the "Hoosick Road" (the  
Albany Road of 1753-1754) presently  
South County Road, crossing an area  
known as "Flat Rock," and also  
North Pond. (Mass. State Archives,  
3rd series, vol. 118, p. 156, #767)

Flat Rock

containing 7350 acres laid out on Hoosick. The whole  
is a great tract by the great & general land grant  
of the province of New York who had their land then in the  
the line between the Dutchess & Albany counties  
has copied for me the subscription of 24. 1765

"Bernardston Grant

Excellency the Captain-General and Governor of the Province, with the following Message, viz.

*May it please your Excellency,*

THE House having a Disposition at all Times and on all Occasions to encourage every Art and Science tending to the well-being of this Province, take the Liberty to Address your Excellency, and to desire you would be pleased to give Order that One Hundred of the Province Arms may be deposited in Cambridge for the Use of such Students of *Harvard-College* as may be disposed to acquaint themselves with the Art Military, and to be under the Care of the Governors of said College during your Excellency's Pleasure.

Message to his Excellency.

The Committee on the Petition of *Joshua Lock*, reported.

Read and accepted, and *Resolved*, That the Prayer be so far granted, as that the Petitioner be allow'd to lay out three Hundred Acres of unappropriated Land on *Hoosuck Mountain*, and return a Plan to this Court as soon as may be for Confirmation; on Condition that he erect and keep an House of Entertainment for Travellers on said Mountain, for the Space of seven Years. The said House to be erected within one Year from the Time of the Confirmation of said Grant.

Report on Petition of *Joshua Lock*.

Sent up for Concurrence.

Upon a Motion, *Ordered*, That the Consideration of the Petition of *Thomas Porter* be referr'd till the next Session of the General Assembly.

A Bill to empower the Judge of Probate for the County of Suffolk, to grant Administration on the Estate of *David Outchterlony*, late of Boston, Mariner, deceased.

Bill read.

Read the second and third Time, and pass'd to be engross'd.

Upon a Motion, *Ordered*, That the Selectmen of the Town of *Hadley* have Leave to withdraw their Petition.

Upon a Motion, *Ordered*, That all Matters having had Day in the present Session, and not acted upon, have the same Day in the next Session of the General Assembly. Sent up for Concurrence.

All Matters referr'd.

An engross'd Bill for erecting a Tract of Land in the County of Lincoln into a Town.

Read, and pass'd to be enacted.

The Accounts of the Treasurer of the Province were sent up to the honorable Board.

The Committee on the Petition of *Joseph Buckminster* and *John Jones*, Esqrs; and Mr. *John Clark*, Guardians of the *Natick* Indians, reported.

Report on Petition of *J. Buckminster, &c.*

Read and accepted, and *Resolved*, That the Prayer be granted, and that the said Guardians, having faithfully fulfilled their Trust, be discharg'd therefrom: Provided if it shall hereafter appear that there shall be in their or either of their Hands, any Estate belonging to said Indians or any Individuals of them, they shall be accountable for the same as this Court shall order.

Sent up for Concurrence.

Upon

Joshua Locke was granted 300 acres of unappropriated land on Hoosuck Mountain (along the "Albany Road") by the Massachusetts legislature in 1779 to open a tavern.

Map of a 300 acre tract granted to Joshua Locke, 1771. This land was along the "Albany Road" west of Clark Mountain. (Mass. State Archives, 3rd series, vol. 20, p. 53)

A true Copy of a Plat of Land Layd Out for - Locke's Land lying on Hoosac Mountain. - Taking Departure from a bearing of the N. E. corner of the Plat, thence running N. 2.° E. 480 Rods to a small creek, then S. 10.° E. 100 Rods to another then S. 2.° N. 400 Rods, then N. 10.° E. 100 Rods to the first mentioned bounds

Surveyed June 3. 1771

Surveyed & borne by Sam. Taylor

Buckland Sept. 6. 1782

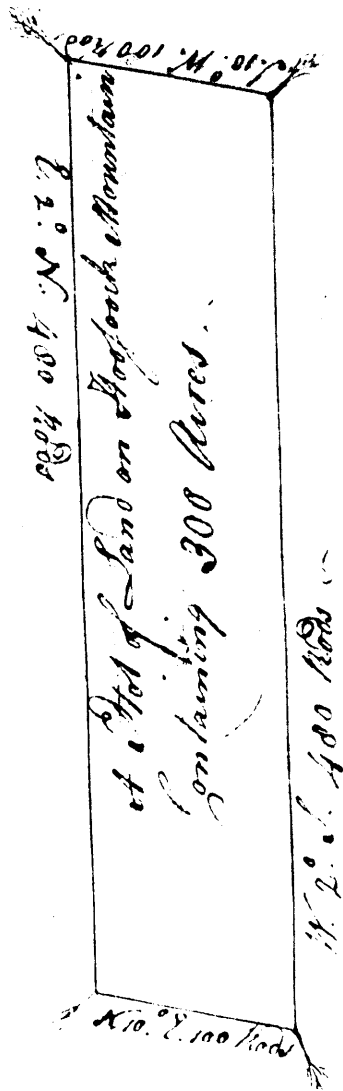
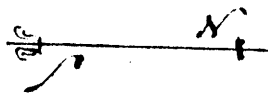

From Locke Papers  
No. 1122  
1782

300 acres on Hoosac Mountain, to Mr - Locke.

1771.

part of map of Williamstown, 1795,  
showing the "Albany Road" running  
over Bee Hill and Berlin Pass. The  
road to the east is labelled "road  
to Adams & Boston" & "county road."

(Mass. State Archives, 1794 series,  
vol. 5, p. 6, #1062)



# Plan of Charlemont in the County of Hampshire By a Scale of two hundred Rods to an Inch

Drawn by Japhet King

the Reported Distance from the Center of Charlemont to Bepton is one hundred twenty miles  
and from Northampton which is the Shire town of the County thirty four Miles.

Forbes Library

Transcribed from the original map of 1794.  
in the Department of Agriculture at the State  
in Boston, by A. S. Appleton, 1898.

Line Between Rowe and  
Charlemont was Run Novr 1792  
Beginning at the N. W. corner of  
Charlemont a hemlock tree and  
heap of Stones thence Run East  
3-40 South 920 Rods to a stake  
and heap of Stones on the west line  
of Heath Being the Easterly Corner  
Between Rowe and Charlemont

Lines Between Heath and Charlemont was Run  
November 1792 Beginning at a Stake and heap of Stones  
Being a corner of Rowe and Charlemont on Heath's right Line  
thence S. 2° E. 200 Rods then E. 4° S. 20 Rods  
then S. 1° W. 90 Rods then E. 10-30 S. 144 Rods  
then S. 9° W. 194 Rods then E. 11° S. 114 Rods  
then S. 2° E. 58 Rods then E. 4° N. 260 Rods  
then E. 25° N. 15 Rods to the County Road  
thence the same course 90 Rods to the  
corner a yellow Birch tree in the west  
line of Colrain

Lines Between Colrain  
and Charlemont was Run  
1794 Beginning at North River  
thence W. 2-30° N. 525 Rods  
then N. 2-30° W. 614 Rods  
to a corner of Charlemont  
a yellow Birch Tree

Line Between Charlemont and Hawley  
was Run 1799 Begins at the South west  
corner of Charlemont a yellow Birch tree  
and heap of Stones thence Runs East 16 deg. 40  
South 1566 Rods to a Stake and heap of Stones the  
North East corner of Hawley line 280 Rods  
from the corner first mentioned.

Line Between Buckland and Charlemont was Run December 1794  
Beginning at the North-East corner of Hawley a Stake and Stones  
thence N. 7° E. 112 Rods to the River  
thence the River called Deerfield River is the Boundary of said town  
the width of 50 River is from 14 to 20 Rods and the course as follows  
W. 3° E. 12 N. 153 Rods E. 25 S. 142 Rods E. 2 N. 62 Rods E. 7 E. 104 Rods  
E. 7 N. 54 Rods E. 18 N. 206 Rods E. 12 S. 320 Rods E. 7 N. 90 Rods  
E. 12 N. 37 Rods E. 20 S. 20 Rods E. 6 S. 180 Rods E. 7 S. 12 Rods  
E. 21 N. 46 Rods N. 16 E. 29 Rods North 23 Rods N. 40 N. 15 Rods  
N. 13 W. 33 Rods N. 40 E. 96 Rods E. 4 N. 42 Rods E. 7 S. 62 Rods  
to the mouth of North River so called the middle of which River  
is the Boundary Between Shelburne and Charlemont thence as  
follows Survey 3 March 1795 the N. 40° W. 60 Rods thence same course 20 Rods  
then N. 6 E. 40 Rods N. 19 E. 42 Rod N. 34 E. 21 Rods to Colrain South Line

Map of Charlemont, 1794, showing  
the "Albany Road" as the "County  
Road" running along the Deerfield  
River. (Forbes Library, Northam-  
pton)

On March 24, 1786 the Massachusetts State Senate authorized the making of a "Waggon road over Hoosuck Mountain." (Mass. State Archives)

Friday March 24 - 1786 -  
Met according to adjournment  
Present

Hon <sup>ble</sup> Sam <sup>l</sup> Phillips Jun <sup>r</sup> & Trus <sup>r</sup>	
Sam <sup>l</sup> Maher	William Phillips
Thomas Duffee	Eleazar Brooks
Stephen Choate	Caleb Strong
Solomon Freeman	Israel Nichols
Charles Turner	Jeth <sup>o</sup> Markburne
Cotton Tufts	Stent Bridge
Joseph Mosner	Nath <sup>l</sup> Wells
Eliza May	Benj <sup>l</sup> Goodhue
Stephen Metcalf	John Lowally
Thompson J. Skinner	Hugh Orr
Peter Coffin Jun <sup>r</sup>	Peter Coffin
	Richard Branch
	Joseph B. Varnum

New Bowdoinham

Esq<sup>r</sup>

The Senate reconsidered their vote of nonconurrence on a Resolve of the House, on the Petition of Isaac Coit on behalf of the Town of Southwick - & concur with an amendment at it — sent down for concurrence  
came up concurring

Resolved for making a Waggon road over Hoosuck Mountain — sent down for concurrence

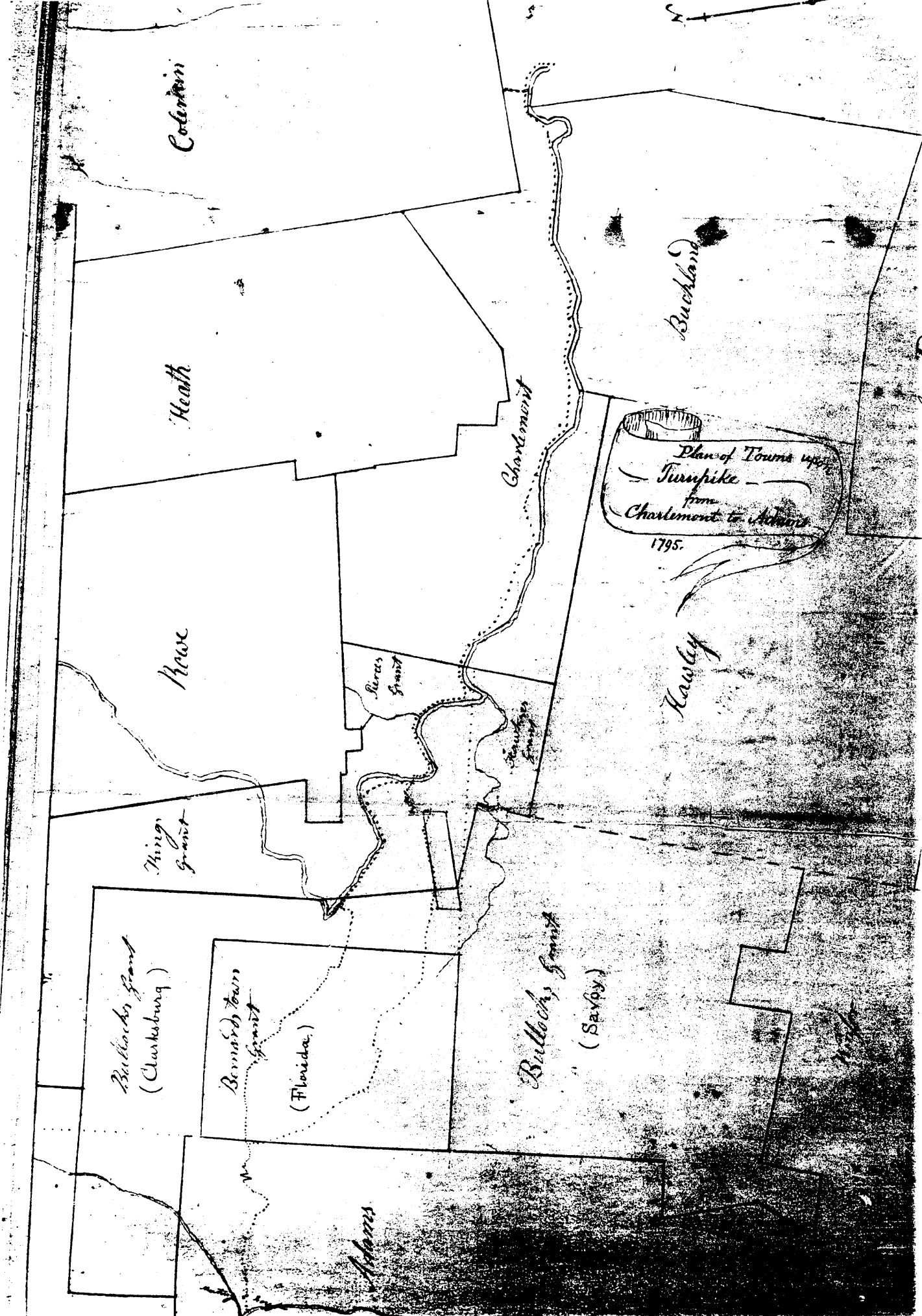

Plan of Towns upon Turnpike from  
Charlemonit to Adams, 1795  
(Mass. Archives: 3d series, Vol. 25  
p. 2, Map No. 1446)





## PROVINCE LINE

			KINGS GRANT (B)					
8	9	10	11	12	13	14		
7	6	5	4	3	2	1		
109	128	136	137	144	73	27		
119	129	135	138	163	74	26		
125	130	134	139	117	75	25		
126	131	132	140	104	76	24		
270	30	31	34	36	38	165	166	22
28	29	32	33	35	37	167	168	21

KINGS  
GRANT  
(A)  
R O E

CORNELIUS  
JONES  
GRANT

LOT A.

LOT B.

NOW  
FLORIDA

BERNARDSTON

GRANT

Scale 200 Rods to an inch

Map of Florida and Vicinity  
from Compilation of the Proprietors  
Lots, Grants . . . 1922-1923  
Registry of Deeds, Northern  
District, Bekshire County

55 HOWES GRANT

60 LOCKS GRANT

NOW CHARLEMON,  
"BOOTLEG"

HAWKS

Disputed  
Corner

The map illustrates the Bullocks Grant area, divided into a grid of sections. The sections are numbered as follows:

- Top row: 94, 95, 96, 97, 98, 99, 150, 151, 164, 63
- Second row: 92, 91, 90, 89, 88, 87, 86, 85, 152, 153, 16, 17, 18, 19, 133
- Third row: 83, 82, 81, 80, 79, 78, 77, 70, 148, 187

Lettered sections A, B, C, D, E, and F are located in the upper right portion of the map. A winding river flows through the center, with a 'Cold Spring' label near its upper right end. The word 'HAWKS' is written vertically on the right side. A 'Disputed Corner' is marked with a dashed line in the bottom right. The title 'BULLOCKS GRANT' is centered in the middle of the map.

...where from the warrant to me directed as the officers of the County of Hampshire to ... lay out abouting road from ... to ...  
... James Parker John Norton John Hopestill Hastings Noah Nash and ...  
... all freehold ... Town of Hatfield  
... one of his ...  
... at ...

**220** Cap<sup>t</sup> Elijah Williams house lot from thence to ...  
then to turn southerly in y<sup>e</sup> South path going down into narrow meadow  
the foot of y<sup>e</sup> hill y<sup>e</sup> road to be four rods wide from thence round near y<sup>e</sup> ...  
until it comes to ... and then only south side of y<sup>e</sup> ...  
lot one half of y<sup>e</sup> road in y<sup>e</sup> ... together half in y<sup>e</sup> lot next ...  
running westerly to y<sup>e</sup> bank of Deerfield river then northerly only ...  
of y<sup>e</sup> ... tree with several stunts by y<sup>e</sup> y<sup>e</sup> road to be two rods  
wide y<sup>e</sup> thence westerly over Deerfield river then to turn northerly upon  
slant of y<sup>e</sup> hill until it comes unto y<sup>e</sup> road wh<sup>ch</sup> cometh unto out of y<sup>e</sup> ...  
called Oldfort the road to be 10 rods wide, thence turning in y<sup>e</sup> southerly road ...  
up y<sup>e</sup> ... hill as y<sup>e</sup> path now goes thence on y<sup>e</sup> hill as y<sup>e</sup> ...  
until it come to a gutter near ... called there to turn ...  
gutter in a low path unto y<sup>e</sup> plain thence to a ... unto a ...  
place where y<sup>e</sup> path goeth of said plain only westerly side then in y<sup>e</sup> ...  
path up a hill until it come unto y<sup>e</sup> other road then in y<sup>e</sup> road as the ...  
goes unto y<sup>e</sup> top of a round hill to a white oak with stones round it, thence  
leaving y<sup>e</sup> road turning northwesterly to y<sup>e</sup> point of y<sup>e</sup> hill where we last  
County heard y<sup>e</sup> stones, thence turning across a small hollow to y<sup>e</sup> east side of a  
road from hill, thence only side of y<sup>e</sup> hill southwesterly until it come to y<sup>e</sup> path ...  
Deerfield from thence in y<sup>e</sup> path now commonly travelled unto y<sup>e</sup> West side of ...  
Hampshire y<sup>e</sup> road y<sup>e</sup> whole of y<sup>e</sup> way to be 10 rods wide, from thence as y<sup>e</sup> road now goes  
line y<sup>e</sup> from y<sup>e</sup> ... as y<sup>e</sup> path now goes going up towards ...  
to y<sup>e</sup> northerly side of y<sup>e</sup> ... farm y<sup>e</sup> road to be four rods wide, thence  
as y<sup>e</sup> road now goes up towards the river crossing y<sup>e</sup> ... in y<sup>e</sup> ...  
place, thence as y<sup>e</sup> road now goes near y<sup>e</sup> foot of y<sup>e</sup> ... hill the ...  
river, thence to turn only southerly side of y<sup>e</sup> ... hill leaving y<sup>e</sup> path to  
continue only side of y<sup>e</sup> hill westerly until it come to y<sup>e</sup> ... only ...  
side of y<sup>e</sup> hill, thence as y<sup>e</sup> path now goes unto ...  
y<sup>e</sup> road to be 10 rods wide thence as y<sup>e</sup> path now goes unto ...  
to be 4 rods wide thence as y<sup>e</sup> path now goes near y<sup>e</sup> foot of a hill in ...  
river, thence to turn out of y<sup>e</sup> path over a small gutter near y<sup>e</sup> ...  
points of land, & thence between y<sup>e</sup> river and a small ... under y<sup>e</sup> hill y<sup>e</sup> ...  
to be 10 rods wide until it come to y<sup>e</sup> path only the side of y<sup>e</sup> hill ...  
now goes unto ... lives dwelling ... y<sup>e</sup> road to be 10 rods wide ...  
places where it is only bank of y<sup>e</sup> river to be 10 rods wide from y<sup>e</sup> top of y<sup>e</sup> ...  
y<sup>e</sup> from y<sup>e</sup> ... his improvements as y<sup>e</sup> path now goes to y<sup>e</sup> ...  
gate from thence by a line of marked trees to y<sup>e</sup> plain to y<sup>e</sup> West side of y<sup>e</sup> ...  
farm y<sup>e</sup> from thence as y<sup>e</sup> path now goes to y<sup>e</sup> ... farm to y<sup>e</sup> ...  
going to ... there over Deerfield river y<sup>e</sup> road to be 10 rods wide  
and y<sup>e</sup> ... Estimate y<sup>e</sup> damage done y<sup>e</sup> proprietors of y<sup>e</sup> improved land in  
Hampshire Meadow in Deerfield ... above mentioned to be at y<sup>e</sup> ...  
of y<sup>e</sup> ... Oliver ... Joseph ...  
Joseph ... John ...  
John ...  
Hampshire May 10th 1754 Then y<sup>e</sup> ...  
applying made oath that in laying out abouting road from Deerfield to  
Charlestown they would act according to their best skill & judgment

The aforesaid return being read in Court is accepted and ordered to be ...  
The aforesaid judgments and Orders made and Entered up at the  
the said Court as journeyed without day  
Att<sup>y</sup> J<sup>r</sup> Williams  
Clerk

Report of survey of a county road  
from Deerfield to Charlemont, con-  
ducted in May of 1754. This became  
part of the "Albany Road." (Hamp-  
shire County Commissioners records)

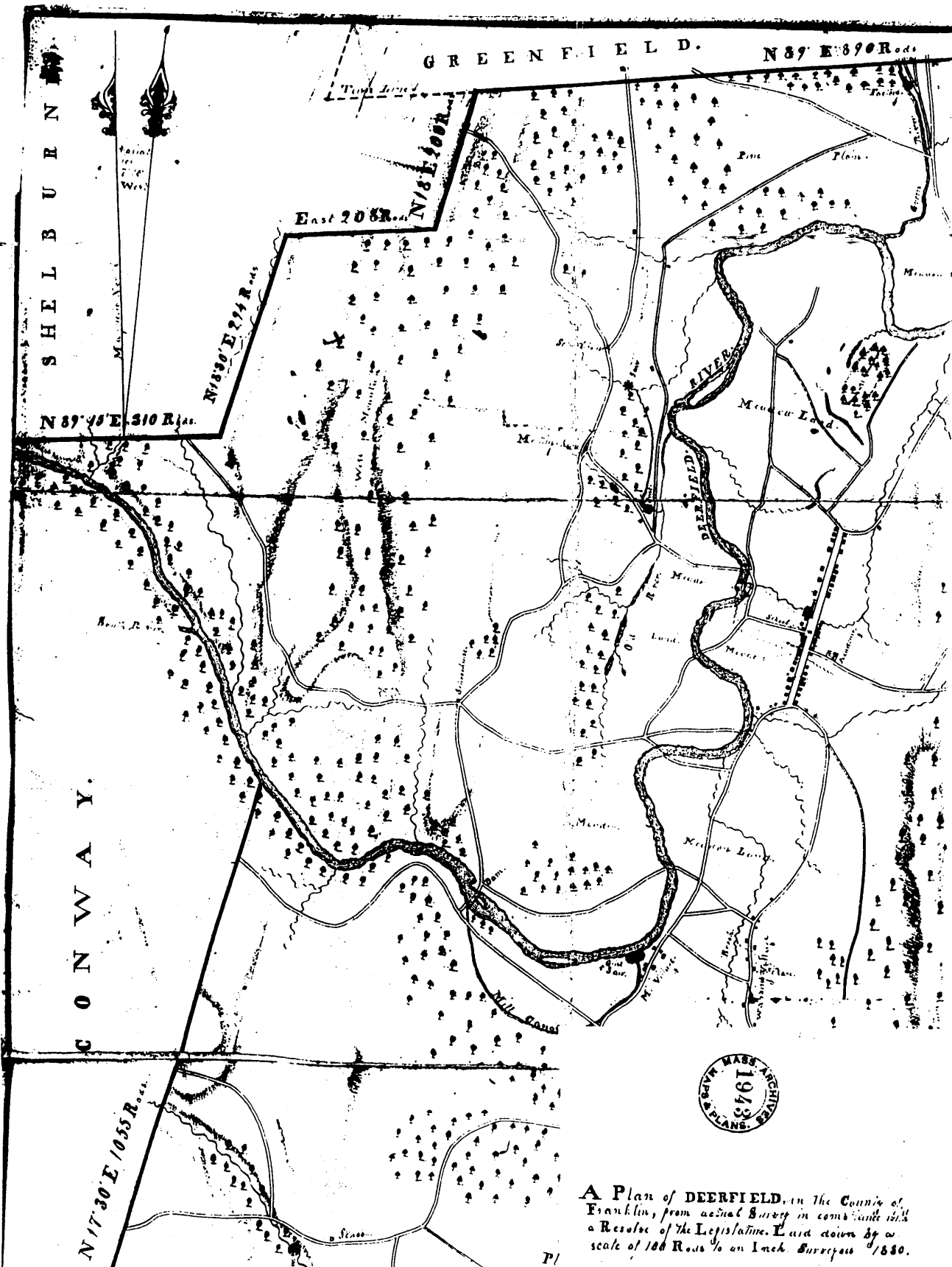

Plan of Deerfield, 1830, by Arthur Hoyt, showing the course of both the original "Albany Road" of 1754 and the altered course of 1762. (Massachusetts State Archives)

A Plan of DEERFIELD, in the County of Franklin, from actual Survey in compliance with a Resolve of the Legislature. Laid down by a scale of 100 Rods to an Inch. Surveyed 1830.

By Arthur W. Hoyt.

Commissary of the records.

Deerfield February 1831.

Distance to the Court House in Greenfield 3 1/2 Miles.

Boston.

Humbly shew<sup>s</sup> Elijah Williams of Deerfield in the County of Hampshire Esq<sup>r</sup> that the High Way or Common Road from Deerfield afores<sup>d</sup> to Charlemont in said County for the space or period thereof from the West end of the burying yard Lane in Deerfield afores<sup>d</sup> in the said Road to Sluice brooks in the same road being a piece of about six miles in Length may be altered and laid on other Grounds northward of said Road for much more Convenience and Advantage to the Public as the Length of Way will be thereby Shortened and the way laid on drier and more feasible Ground The said Elijah therefore prays your Honors Order that the said road may be altered for the space afores<sup>d</sup> in manner as by Law is prescribed And the said Elijah as in Duty bound shall ever pray - Elijah Williams - Read and Ordered that the prayer of the petition be so far granted that a Committee be appointed to View the said Road and if they Judge best to alter the same and lay it out anew - And Nathaniel Dwight of Belchertown gent Joseph Root of Montague gent. Feltow Billing of Sunderland gent. John Guinn of Montague gent. And John Clary of Sunderland yeoman are hereby appointed a Committee to View that part of the s<sup>d</sup> Road afores<sup>d</sup> and alter the same and lay it anew if they shall judge it best for the public Which said Committee are to give Reasonable Notice to all persons interested of the Time.

6  
Elijah Williams Esq<sup>r</sup> Det<sup>r</sup> } Time and place of their meeting and shall be under oath to perform the s<sup>d</sup> Service according to their best Skill and Judgment with most Convenience to the Public and least prejudice or Damage to private property and shall also ascertain the place and course of said Road in the best way and manner they can (if they shall alter the same) Which having done the said Committee or the major part of them shall make Return thereof to the next Court of General Sessions of the peace to be held in said County after the Service is performed under their Hands and Seals And if any person be damaged in his or her property by the laying out said Way the said Committee are empowered and required under oath to estimate the same and make Return thereof as aforesaid - And it is also ordered that the Clerk of this Court serve the said Committee with a Copy of this order -

The foregoing Judgments and Orders were made and entered up and then the said Court adjourned without Day -

AH. W. Williams Cler -

Petition of Elijah Williams to alter the course of the "Albany Road" from the burying ground in Deerfield to Sluice Brook in Shelburne, a distance of about 6 miles.

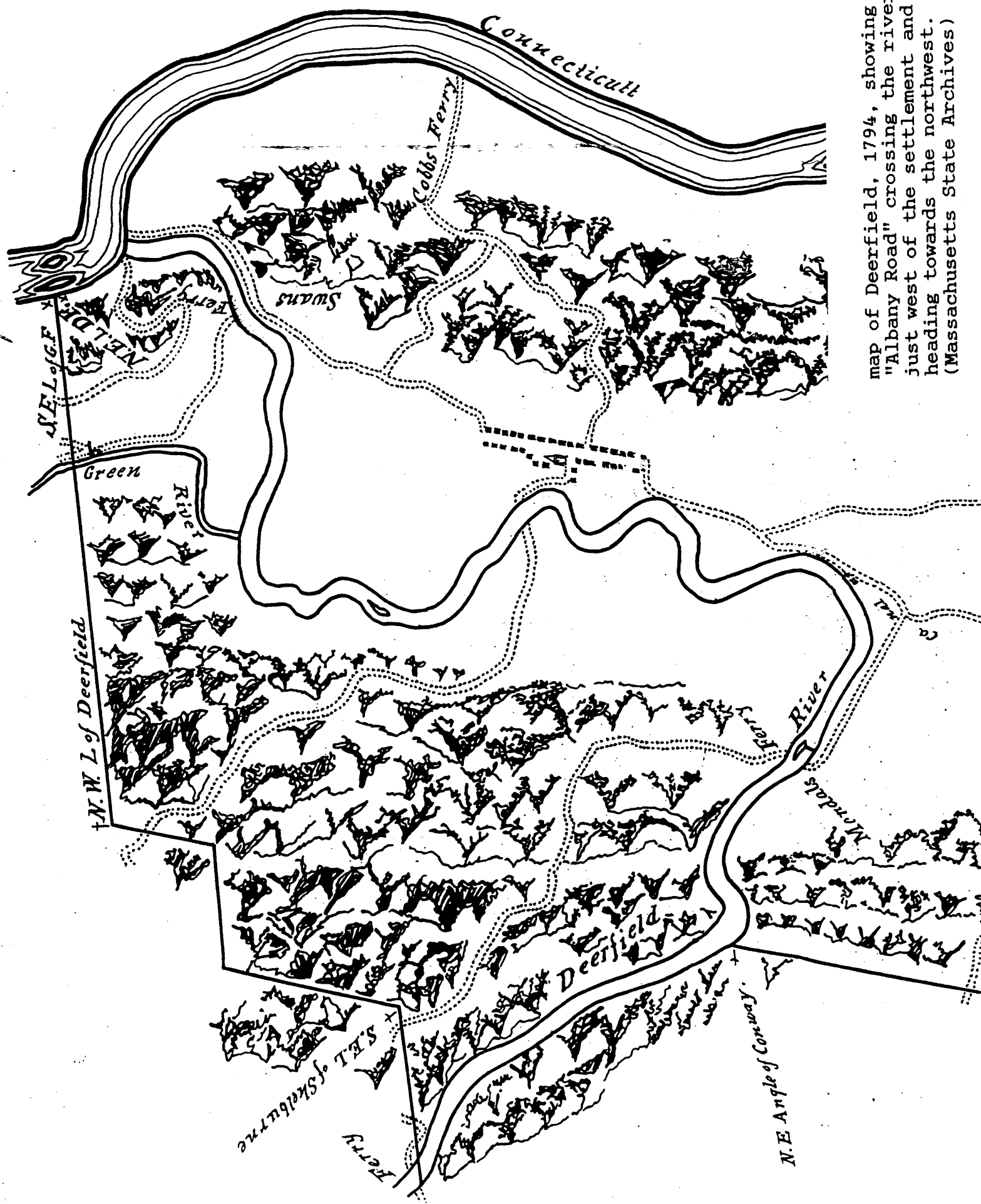

map of Deerfield, 1794, showing the  
 "Albany Road" crossing the river  
 just west of the settlement and  
 heading towards the northwest.  
 (Massachusetts State Archives)

Highway  
from  
Deerfield  
towards  
Charlemont  
Altered

We the Subscribers being appointed by his Majesty's Court of General Sessions of the Peace held at Springfield May Term 1762 To view the Road leading from Deerfield to Charlemont viz from the West End of burying yard Lane so called in Deerfield to Suisse Brooks - Monday May 24<sup>th</sup> 1762 being met together at Deerfield afores<sup>d</sup> and sworn to the faithful performance of the Service We rode out and Viewed the Road about forty or fifty rods over Suisse Brooks and being agreed to alter said Road & lay it out anew began at a white pine tree about forty or fifty rods west of Suisse Brooks on the north side of the road Mk<sup>d</sup> with y<sup>e</sup> Letter H and a heap of Stones at the Root and from thence the Road runs East 20° South 169 rods to a small white oak Mk<sup>d</sup> H. then East 38° N. 16 perch to a small Hemlock Mk<sup>d</sup> H. East 9° N. 39 perch to a birch tree Mk<sup>d</sup> H. East 43° S. 28 p. to a hemlock Saddle Mk<sup>d</sup> H. East 26° S. 62 perch to a hemlock Tree East of Dragon Brook at the upper ford, East 14° S. 59 perch to a Horse Saddle near the Top of the hill Mk<sup>d</sup> H. East 34° N. 40 perch to a beech Tree Mk<sup>d</sup> H. East 15° N. 69 perch to a small hemlock Mk<sup>d</sup> H. East 33° N. 22½ perch to a Hemlock Mk<sup>d</sup> H. East 34° S. 81 perch to a hemlock tree Mk<sup>d</sup> H. East 14° S. 60 perch to a chestnut tree Mk<sup>d</sup> H. East 17° N. 40 perch to a red oak tree Mk<sup>d</sup> H. East 2° N. 27 perch to a white oak tree Mk<sup>d</sup> H. East 25° N. 44 perch to a maple tree Mk<sup>d</sup> H. East 35° S. 23 perch to a Chestnut Tree Mk<sup>d</sup> H. S. 10° East 27½ perch to a Walnut Saddle Mk<sup>d</sup> H. East 17° N. 24 perch then East 41° N. 24 perch half a rod East of a Chestnut Tree Mk<sup>d</sup> H. East 13° S. 52. to a small heap of Stones six feet west of a birch tree Mk<sup>d</sup> - thence East 12° N. 40 perch to a heap of Stones, S. 32° East 22 perch to a Chestnut tree Mk<sup>d</sup> S. 1° East 40 perch to a heap of Stones ¼ a rod East of a Saddle Mk<sup>d</sup> H. S. 18° West 18 perch to a heap of Stones at the head of a hollow East 20° S. 39 perch to a white oak tree Mk<sup>d</sup> H. East 35° S. 58 perch heap of Stones Course continued 66 perch in the whole bush Mk<sup>d</sup> East 8° S. 35 perch to a heap of Stones, East 35° S. 50 perch to heap of Stones S. 14° East. 25 perch to heap of Stones, East 35° S. 40 perch to heap of Stones, S. 20° East 24 perch to Chestnut Tree Mk<sup>d</sup> H. East 39 S. 9 perch to heap of Stones, S. 16° East. 23 perch, East 30° S. 19 perch to Chestnut Tree Mk<sup>d</sup> H. S. 20° East 36 perch to a heap of Stones, S. 7° West 26 perch to a heap of Stones, S. 24° West 25 perch to heap of Stones, East 44° S. 29 perch to a black oak Tree Mk<sup>d</sup> H. East 38° S. 36 perch to a heap of Stones by the path S. 16° East 27 perch to a heap of Stones, S. 26° East 50 perch come into the path S. 1° H 32 perch a small Saddle one rod from Col<sup>o</sup> Halobas's fence S. 26° East 12 to a small

Survey of the altered course of the county road between Deerfield and Charlemont in May of 1762. This changed the course of a section of the "Albany Road."

(Court of General Sessions proceedings, Hampshire County Commissioners office)

small pine Mk. S. 2° West 30 to black oak tree by the Brook Mk. H. S. 24° W. 6 p. Highway  
 S. 30° West 50 perch to a small pine Mk. by the fence, S. 9° E. 43 perch to a small Continued  
 pine Mk. H. S. 44° East 35 perch to a pine tree Mk. H. at the top of the hill, East  
 45° S. 40 perch to a small pine stake on side hill Mk. H. S. 20° East 16 perch one  
 rod over the brook a heap of stones S. 10° East 19 perch to pine tree by path  
 Mk. H. S. 41° East 21 perch to a stake S. 36° East 31 perch to an Elm Staddle  
 in the Town Road at Old Fort Mk. H. East 30° S. 42 perch just over the two gutters  
 in Mr. Ashley's Land a bunch of Alders Mk. East 34° N. 18 1/2 perch into the  
 Town road again East 11° S. 26 1/2 perch N. 35° East six perch to river's brink  
 20 in the whole to the East bank of the River, East 29° S. 7 perch up the bank  
 S. 34° East 33 perch to where the paths part S. 16° East 21 perch one rod East of  
 an Elm tree Mk. S. 23 perch, S. 3° W. 20 perch S. 23° W. 17 perch S. 20° East 6  
 into the middle of the west end of the burying yard Lane aforesaid. The Road to  
 be five rods wide from the white pine tree where we first began to Meadow Width the  
 fence and to be two rods wide through the meadow to the end of the Lane  
 aforesaid

John Clary & Seal } Nathl. Dwight and Seal  
 Thellows & Billing & Seal } John Quinn and Seal  
 Joseph Root & Seal

Damage ascertained to sundry persons as -

following - viz To Lieut. David Field - - - - - \$0. 9. -  
 To David Knight's heirs - - - - - " 15. -  
 To Rev. Mr. John Ashley - - - - - " 5. -  
 To Lieut. Timothy Childs - - - - - 1. 5. -  
 To Elijah Williams, Esq. - - - - - " 12. -

Joseph Root } Nathl. Dwight  
 John Clary } Thellows & Billing  
 John Quinn

The foregoing Return was now made and this Court having  
 read and considered the same do accept and allow it. & it is ordered that y.  
 Return be recorded in the Records of this Court and the Way therein des-  
 cribed after known for a public Highway as altered as aforesaid And the s.  
 estimate of the Damage occasioned to several persons above named is also  
 allowed by the Court. It is ordered that they be satisfied the same by the  
 town of Deerfield -



Committed  
 in Deer-  
 Road  
 their-  
 Auto

The County of Hampshire to Nathaniel Dwight and others for their service in altering the Road leading from Deerfield to Charlemont. —  
 viz to the said Nathaniel for three days @ 7/10 — \$1.1. —  
 To Joseph Root do for three do @ 4/6 — 0.18. —  
 To Hollows Billing do for 3 do @ 4/6 — 0.18. —  
 To John Gunn do — 0.18. —  
 To John Clary do — 0.18. —  
 To John Taylor Chairman 2 days @ 3/6 — 0.6

This amount was now presented to the Court by Capt. Dwight who prays the same may be allowed & this Court having inspected y<sup>e</sup> same do allow it & it is ordered that the County Treasurers be directed to pay the persons above named the several sums annexed to their respective names out of the County Treasury —  
 Order is: Sept 16<sup>th</sup> 1862

Nathaniel Dwight and other submit  
 their expense account for altering  
 the road from Deerfield to Charle-  
 mont in 1762. (Hampshire County  
 Commissioners Records)

# Shelburne

Bounded East on Deerfield and Greenfield; North on Colrain, West and South on North River (so called) and Deerfield River which divide it from Charlemont, Buckland, and Conway.

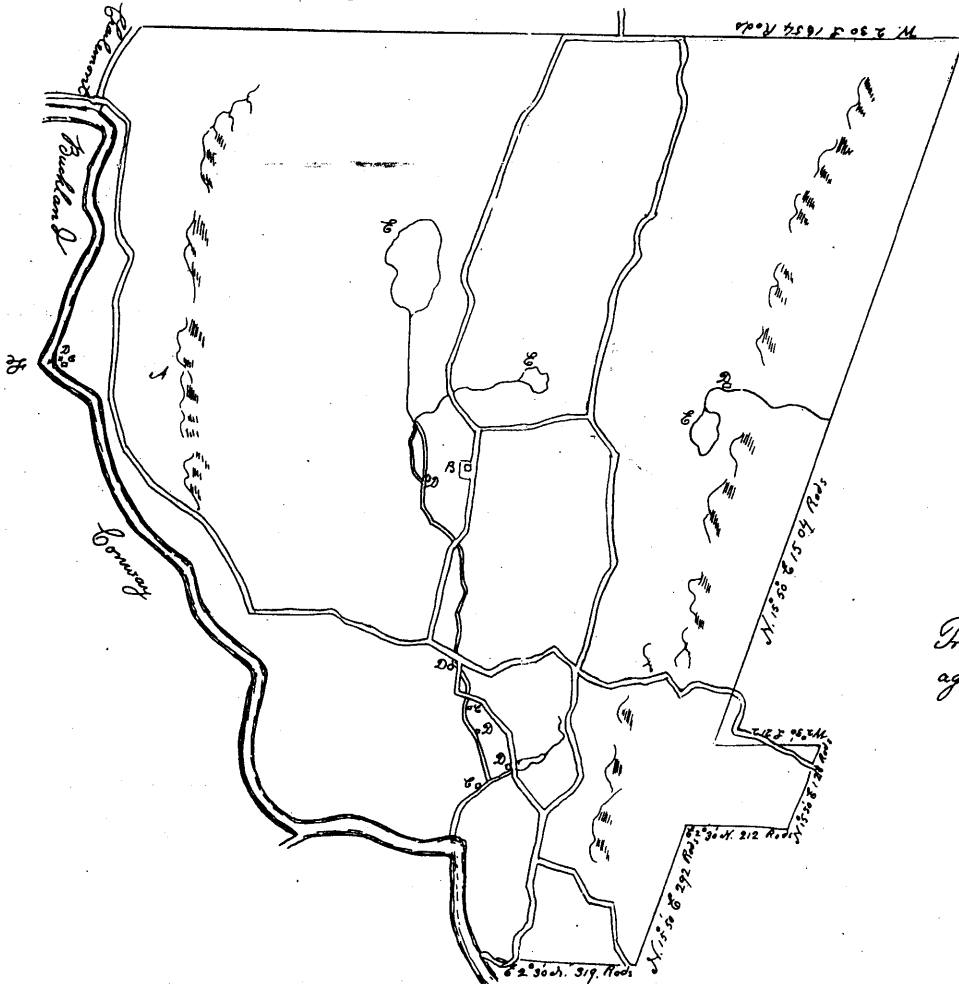

## References

- A. Bald Mountain
- B. Huntington 120 miles from Kepton 25 from Northampton
- C. Grafton Mills
- D. Sawmills
- E. Marshponds
- F. Falls 15 feet perpendicular - North West angle of Conway

Protracted from a Survey made Nov<sup>r</sup> 1794  
agreeably to resolve of Court

Moses Hawks } Committee for  
John Wells Jun<sup>r</sup> } Surveying Town.  
Wm = Bull

## Torbes Library

Trans from the original map, Vol 7, map 26,  
in the Department of Archives at the State  
House in Boston, by H. S. Appleton Dec 1899.

Map of Shelburne, 1794  
showing both the 1754 and 1762  
courses of the "Albany Road  
joining at Shelburne Center.  
(Forbes Library, Northampton)

Hawks, 17 The Petition of John Hawks Esq, Nathan Ashley Junr Esq and Thomas William  
others Esrs. all of Deerfield in the County of Hampshire humbly pray your Honors and  
Petition permit your Petitioners to put down a small pond with two small Weirs in  
Deerfield River above the Road that leads from S. Deerfield to Charlestown for  
the purpose of taking Salmon said Pond not to extend across the River so  
to prevent or turn the natural course of the fish. Read and ordered that the  
Petitioners be and they hereby are allowed to erect such a pond as aforesaid in  
River above the S. High Way with two small weirs as aforesaid to be removed  
Continued during the pleasure of the Court

John Hawks and others of Deerfield  
petitioned the General Court in  
1762 to construct a salmon trap in  
the Deerfield River near the Albany  
Road. (Hampshire County records)

(5)

*General Reflexions and Remarks on the State and Disposition of  
New England and particular Descriptions of Worcester in Mas-  
sachusetts Bay and other parts of the four Provinces, tending to furnish  
Ideas and Hints towards a Plan for its speedy Reduction to the legal  
Authority of Parliament*

*not dated*

*Auctored Manuscripts at King's College, Cambridge.*

*For similar ideas to those in the first four pages of this paper see  
132 "State of Facts to prove against popular and received Opinions"  
in the hand of Paul Wentworth.*

This undated manuscript (probably dating from the mid-1770's) found at King's College, Cambridge, U.K., entitled "General Reflections and Remarks on the State & Disposition of New England . . .", probably was compiled for British military intelligence purposes. It mentions three major roads from the seacoast to Albany. The "other New Western Road" of 150 miles ran from Deerfield over the mountain to Fort Massachusetts, then to Greenbush & Albany, "passing thro' a country not well settled."

from B.F. Stevens' Facsimiles of Manuscripts in European Archives Relating to America 1773-1783, Vol. 1, #2. [New York State Library]

Ship Timber are brought to Boston & Charlestown in Rafts. It rises also near Hopkinton under the name of Deer R. to the Southern Extent of the Province. It soon acquires the name of Charles R. at Bellingham, & meanders thro' the finest country in very irregular bends and courses till it reaches Watertown, whence proceeding more regularly it falls into a Bay, which still retains the name of Charles till it empties itself into Boston Bay. The Townships are Bellingham, Concord, Blackstone R. Wrentham, Medway, Holletstown, Medfield, Sherburn, Natick, Needham, Dedham, Weston, Watertown, Newton Brookline, Cambridge & Charlestown.

The post & Wagon Roads should be noticed but as it is presumed that the Comm<sup>r</sup> in Chief has caused the Publick records to be collected & from the returns of the Surveyors the post office & other perambulatory Annotations, has ordered an accurate State of the Roads, Heights Rivers & other Communications I shall only mention a few of these here, as being necessary to the prosecution of the plan suggested.

1 The Great Post Road from Portsmouth to New York follows the sea coast, except from Boston to Providence where it deviates, as one would wish it, for the projected line of Division & defence. From Boston it runs thro' Roxbury to Dedham 11 miles where an Army may find Room, Cover & Safety. then at about 5 miles distance from a nearly parallel

Parallel with Charles R. intersecting  
the Towns of Wrentham (16  
miles from Dedham) another  
encamping Quarter, thence thro  
Attleborough & Seekonk 16 miles  
more, still nearly parallel to  
Charles River - (at Seekonk meets  
a plain spacious enough for the  
largest Armies at only 2 miles  
Distance from Providence making  
in all 43 miles from Boston as the  
Road runs.

The Old Great Western or Waggon  
Road from Portsmouth to Boston  
about 62 miles, & from Boston to  
Albany about 200 miles - through  
Charles Town, Cambridge, Medbury,  
Waltham, Concord, Sudbury, Marl-  
borough, Westborough, Worcester,  
Leicester, Brookfield, Western, Kingston  
& W. Springfield, Westfield, Granville,  
Colebrook, Sheffield, Northfield,  
Jansons Ferry, Claverac, Kinder-  
hook, Greenbush, Albany.

3 There are two later Roads, & shorter  
from Portsmouth to Albany about  
130 miles, thro Kingston, Londonderry,  
Litchfield, Dunstable, Mason,  
Rowley or Rindge, Winchester, Hinsdale,  
Port Dummet, near the Peninsula  
of Ashuelot R. Brattleborough,  
Marlborough, Wapet, Woodford,  
Bemington, Plausick, Vander-  
heyden's Ferry, Albany.

2 The other New Western Road from  
Boston runs nearly parallel to this  
at no great Distance & is but 150 from  
Albany, thro Charles Town, Medbury,  
Concord, Lancaster, Petersham, &  
East Branch

12  
Eastbranch R. which falls into Shickabe  
R. Sunderland, Deerfield, or  
Deerfield R. a considerable stream  
extending to near Housick R. & Fort,  
or Fort Massachusetts, Greenbush,  
Albany. These two Roads, however  
passing thro a Country not well  
settled, affords no great dependence.  
Before I proceed to the Coasts & Mouths  
of Rivers, I shall take some notice  
of the Heads of the Great Rivers falling  
into the Atlantic, & those falling into  
the River St. Lawrence from Sturgo  
to Quebec; both having very easy  
communication by the Lakes from  
whence they rise, & the carrying places  
over small distances.

1 Hudsons R. flows in 12 hours to  
Albany being as the River runs  
about 140 miles from New York.  
Albany is a Pass of the greatest  
importance, central in regard  
to the material - collateral operations,  
affording convenient Communications  
with every part; & hinderance to  
the Succour which the Western  
Provinces might otherwise give to  
the New England Provinces

2 Sturgo, on Lake Ontario, is another  
Pass of importance; tho it does not  
make a Part of the projected plan,  
yet it is very usefully situated to  
Protect the Indians and their Trade  
& to prevent them from furnishing  
Aid and Ammunition to the Colonists  
- a Line continued & supported from  
hence to Niagara, Fort Duquesne  
or Pittsburgh, the Great Senhaway  
River & the great Cherokee River  
would secure the Indian Trade to  
Canada, prevent the French now  
Spanish

6

Nelson Hull, in his *Reminiscences of the Settling of the Valley of the Little Hoosick* (1858), wrote that "in the course of three years [from Daniel Hull's settlement in the present Berlin in 1770] a highway opened to Williamstown, Mass." This infers that the road over Bee Hill and Berlin Pass was a later part (1773) of the Albany Road.

13

Neither would it be injurious to the youthful descendants of this time, who are enjoying affluence, (if compared with the times of their ancestors,) I cannot vouch for the truth of every pioneer family suffering, but I presume to say, what was the deprivation and toil of one, nearly in the same wake followed others. By the loss of my mother in infancy, I was adopted into my grandfather's family, Peter Hull, son of Daniel Hull, who was ten years old, when his father moved into this country. In my affections, I knew no other parents, calling them father and mother, and living with them to the day of their death. From him I received most of my information, in relation to their suffering in those early times. My father, as I ever called him, was one of those sober, dispassionate men, strictly an every day Christian, and adoring his Saviour God to the day of his death. Whom I never dare harbor a doubting thought in regard to the truth of any assertion that fell from his lips. He has often, when in my childhood, and much later, giving me the account of those early sufferings and later and better days. Also from his brother, the Rev. J. Hull, and D. Hull, Jr. They seldom made him a visit, (which was frequent,) but the conversation turned upon those days of deprivation. He scarce ever spoke of these times and things but the tears flowed from his eyes.

When they, (D. Hull and family,) arrived at their new home, their provisions were nearly consumed. Means must be taken to replenish their store. This from a howling wilderness was a poor market to look for stores for subsistence. Bears and deer and other game roamed in the forest. The brooks were alive with trout, but they wanted time to take it. Every moment must be employed in clearing up the lands to raise grain for bread, and increase their other store of necessities of life. Corn they bought of the Dutch, in the Brimmer neighborhood. To get it ground, they were necessitated to carry it on horseback to a mill near the Federal stores, now West Nassau. The whole of this way was, or nearly, a dense forest; the roads consisted of nothing but paths



most of the way. The distance full twenty miles, and usually required about three days to make one of those mill journeys. In the course of three years a highway opened to Williamstown, Mass., the distance was shortened, but it often took three days to get a grist ground there and home. There was no mill in the Valley of the Hoosick, till the year 1779 or 80. This was erected by a Mr. Trial, afterwards called the Bates' Mill.

No milk, butter, or meat, except occasionally some wild game. They got buttermilk of the Dutch; on this and corn bread they mostly lived. The second year they had a small crop of wheat, and purchased a cow. Fare was a little better. The cow had to be turned into the woods to get her living, if she roamed too far away that they could not find her, the family went to bed without supper, or supped on dry bread, which was often the case, and in later times, (the cows and other stock browsed in winter.) The second year they also raised some pork. The means for raising or fattening pork was almost wholly on wild nuts, for several years. The little store of pork laid in was generally consumed at an early day in the Spring, if not long before. When Spring opened, they commenced making sugar from the maple. To make up for milk, which they seldom had at this season, they substituted sap-porridge, several dishes were seasoned with this beverage (maple sugar), it also took the place of butter. Their facilities for making it were such, they could obtain but little. The sugar seldom lasted longer than the spring months; for the remainder of the year milk and bread served them for food.

They suffered much from the cold; it was not uncommon to rise in the morning with their beds covered with snow to the depth of several inches. Their houses open, their furniture consisted of few articles of the simplest kind. Their outside clothing consisted of a coat of flannel or linsey wool, in fashion not dissimilar from a hunting coat; a jacket of the same, if they could get one; short breeches, almost invariably of leather, either buckskin or sheep; shoes and stockings.

7

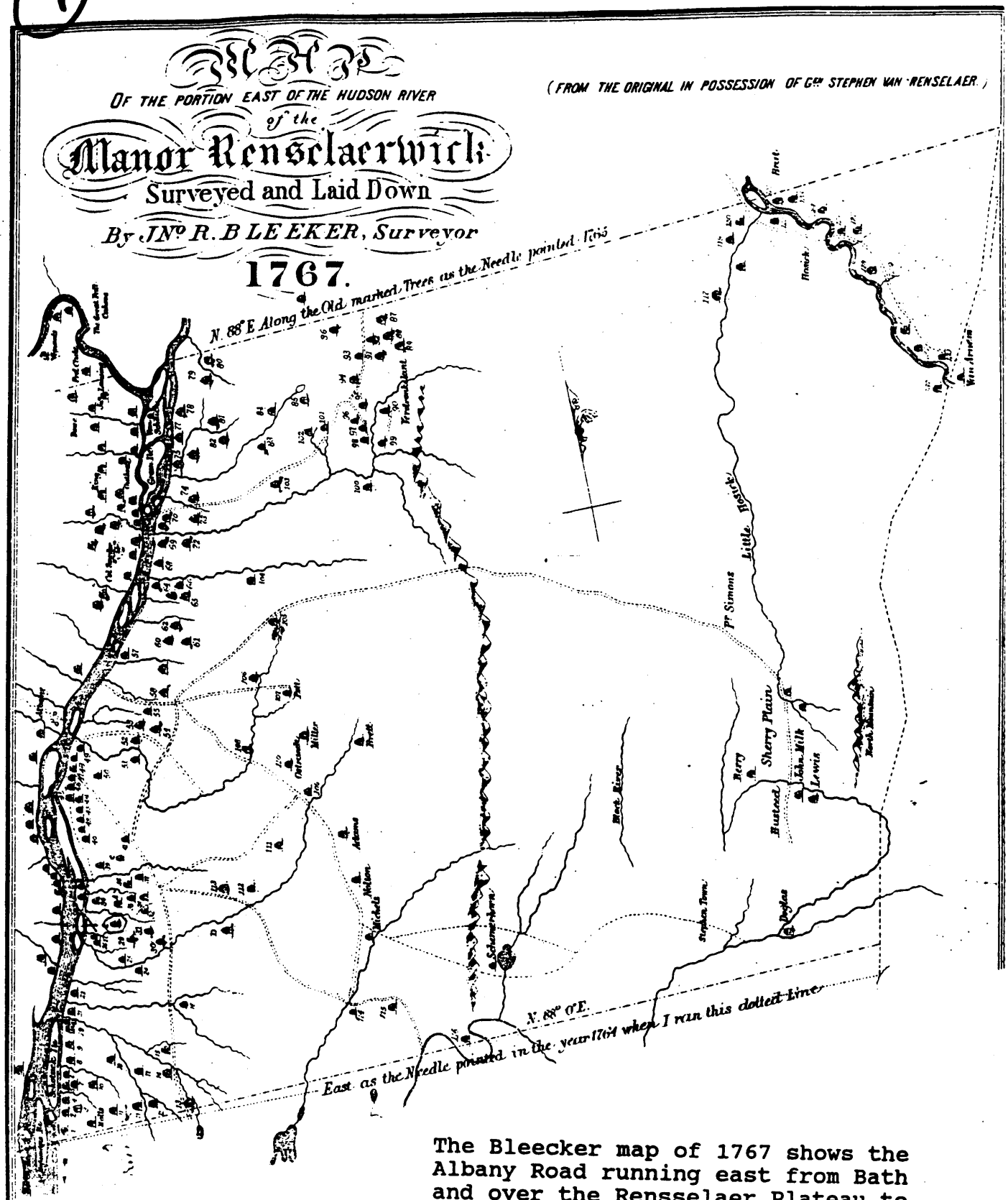

The Bleecker map of 1767 shows the Albany Road running east from Bath and over the Rensselaer Plateau to the house of Peter Simmons, south of Berlin. It there intersects a road running south towards Stephentown. Roads running north and east of Peter Simmons' house at "Little Hoosick" are not shown in this map. [from Sylvester's county history]

27 And the one other Road belonging to the Manors  
 at Jan Bens Pat. or Road thence continued East  
 as the Road now runs to Edward Hegels at the South  
 side of his House as the road now runs and so east  
 along the North side of Lawrence Keydaphs fence  
 and continued easterly as the road now runs to the  
 House of Machariats Keller at the South side of his  
 House about 20 Yards and continued easterly to the  
 House of Nicholas Keller at the North side of his House  
 and so to the Grist Mill at the North side of the Mill  
 so to the House of Hendricks Sepirley at the South  
 of his House so to the Three Square Lake to the South  
 side of the Lake from thence to the House of Math  
 Rucard. between the House and Barn from thence  
 to the House of John Carpenter to the North side  
 thereof from thence Easterly to the House of John  
 Keller to the North side thereof and so continued  
 the East Side of his Land and from thence continued  
 in the most Direct and convenient Place  
 to the Little Hoosick valley.

And the one other Road of the Manors at Little Hoosick  
 situated one other road from where the road goes into the  
 Bushes to the Northwardly nearly along the side of the  
 River as the road now runs to north. Bounds of the  
 Manor of Rensselaerwyck.

description of the portion of the  
 "Albany Road" between Bath and the  
 Little Hoosick valley, by the High-  
 way Commissioners for the Manor of  
 Rensselaerwyck, 1773

[from Field Book of Highways in . .  
 other counties, 1770-1792, Albany  
 County Hall of Records]

# THE COLONIAL LAWS

OF

## NEW YORK

FROM THE

YEAR 1664 TO THE REVOLUTION,

INCLUDING THE

CHARTERS TO THE DUKE OF YORK, THE COMMISSIONS AND IN-  
STRUCTIONS TO COLONIAL GOVERNORS, THE DUKES LAWS,  
THE LAWS OF THE DONGAN AND LEISLER ASSEM-  
BLIES, THE CHARTERS OF ALBANY AND NEW  
YORK AND THE ACTS OF THE COLO-  
NIAL LEGISLATURES FROM 1691  
TO 1776 INCLUSIVE.

### VOLUME V.

Chapter 1671 of the Colonial Laws of New York provided for oversight of highways in Cumberland County (now part of southern Vermont) It specifically mentions a road "lately" [ca. 1773] laid out from Brattleboro on a southwest course to Pownal, and thus allowing one to travel to Albany. This road apparently connected with the "Albany Road" at Fort Massachusetts, a road which had been in existence previously. [The original law is held by the N.Y. State Archives]

TRANSMITTED TO THE LEGISLATURE BY THE COMMISSIONERS OF STATUTORY  
REVISION, PURSUANT TO CHAPTER 125 OF THE LAWS OF 1891.

ALBANY:  
JAMES B. LYON, STATE PRINTER.  
1894.

(88)

## [CHAPTER 1674.]

[See chapter 1311. Expired, February 28, 1777.]

An Act to amend an Act entitled "An Act for laying out regulating and keeping in repair common and public Highways in the County of Cumberland," and to facilitate the raising the County Charges in the said County.

[Passed, March 9, 1774.]

WHEREAS in and by the said Act abovementioned it is amongst other Things enacted, "That if any Disputes shall arise with respect to the most convenient Place of making a Road, or the joining of Roads from Town to Town, that then it shall be in the Power of the Commissioners or the major Part of them in such Town or Towns to call in three Commissioners one from each neighbouring Town who shall determine where the said Road shall be, as they or the major Part of them shall think to be most convenient, as well for Travellers as for the Inhabitants of every such Town and the next adjacent towns," which Mode so prescribed hath not been found to answer the good Ends thereby proposed, more especially as sufficient Powers are not therein given for carrying the Matters thereby enacted into execution, for remedy whereof.

*Be it Enacted by his Excellency the Governor the Council and the General Assembly, and it is hereby Enacted by the Authority of the Same,* That if any Disputes have already arisen or shall hereafter arise with respect to the most convenient Place of making a Road or the joining of Roads from Town to Town, or District to District, or upon the Complaint of three or more Freeholders or Inhabitants of the said County of the Inconvenience of any public Road or Roads, now or hereafter to be laid out through the same, to the Court of General Sessions of the Peace for the same County, in all Cases of such Disputes or Complaint as beforementioned, it shall and may be lawful to and for the said Court of General Sessions of the Peace, and they are hereby directed and required if they see just Cause to appoint Commissioners for the Purposes aforesaid, which Commissioners so appointed are hereby authorized required and commanded to go to the Place or Places about which such Controversy arose, or Com-plaint shall have been made, and to determine and fix where such Roads respectively shall be laid out and made, or where

any such Road or Roads from Town to Town or District to District shall join, and to certify the same to the said Court at their next Meeting, which being approved of by the said Court shall be recorded by the Clerk of the Township or District through which such Road or Roads shall be so laid out, and shall be the Public Road or Highway through the Place or Places where the same shall have been so laid out by the Commissioners appointed by the said Court, which said Commissioners shall be paid in equal Proportions by the several Townships or Districts in which they shall perform the Services required by this Act, the like Sums, and to be levied in the same Manner as the Sums allowed to the Commissioners of the several Townships and Districts in the said County; And that when the said Commissioners or the major Part of them shall have determined where the said Road shall be, or where the said Roads from Town to Town, or District to District shall join, That the Surveyor and Overseer or Surveyors and Overseers of the respective Town or Towns District or Districts where such Road or Roads shall be determined or ordered to be laid out or be, shall proceed to warn the Inhabitants respectively, and set them to work, and cause the same to be laid out opened and made, and from Time to Time worked on and kept in repair in the same Manner as the other Roads in the said County are by Law ordered and directed to be done, and that all other Road or Roads to be hereafter laid out in the said County, shall be also recorded by the Clerk of each respective Township or District within the same through which such Road or Roads shall be laid out; and that no Road or Roads hereafter laid out, shall be deemed or taken as a public Road or Roads, except the same be so recorded as aforesaid.

*And be it further Enacted by the Authority aforesaid,* That the Inhabitants being Freeholders of the Township of Westminster in the said County, and who live on the Town Street of the said Township, or who own Lands bounded thereon shall each of them work three Days in the present year in clearing opening and repairing the said Town Street to the Breadth of ten Rods, which Service the Surveyors of the said Township or any one or more of them shall warn the said Inhabitants to perform and shall see the same performed accordingly, and which said three Days shall be deducted from the Number of Days such Inhabitants are directed to work according to Law, and that any Overseer or Surveyor of Highways who shall refuse or neglect to do his Duty in any of the Matters aforesaid as by this Act is directed,

shall forfeit for each such Neglect or Refusal the Sum of ten Pounds lawful Money of New York to be sued for recovered, levied and applied as herein after is directed.

*And be it further Enacted by the Authority aforesaid,* that every Inhabitant within any Township or District in the said County of Cumberland being a Labourer or Tradesman and no Freeholder or Housekeeper, shall be obliged to work only three days in each Year on the Highways at such Times as they shall be warned or summoned for that Purpose by the Surveyors or Overseers of the Highways or one of them in the Township or District where such Person or Persons shall staidly reside, and that indented Servants who live with and labour for their Masters, and Young Men who live with and labour for their Parents not being Freeholders shall be exempted from the Burthen of working on the Roads on their own Accounts.

*And Whereas* some few of the Inhabitants of the said County of Cumberland have lately with great Labour and Expence, laid out and opened a Road from Connecticut River towards the City of Albany running Westward through the Townships and Tracts of Land called Brattleborough, New Marlborough, Whiting and Draper in the County of Cumberland, and the Townships or Tracts of Land called Readsborough, New Stamford and Pownal in the County of Albany, which Road if well made and kept in good Repair will be very beneficial to all the Inhabitants in those Townships and Tracts of Land, enable them to carry their Produce to Market and raise the Value of their Lands.

*Be it therefore Enacted by the Authority aforesaid,* That every Freeholder or Housekeeper dwelling and residing in any of the said Townships or Tracts of Land called Brattleborough, New Marlborough, Whiting, Draper, Readsborough, New Stamford, and Pownal shall by himself or by some able sufficient Person in his Room and stead work so long Time as the Commissioners herein after named or any two of them shall judge necessary not exceeding three Days in every Year on the said Road last mentioned where the same passes through the Township or District in which such Freeholders or Housekeepers respectively dwell, and that the respective Overseers of Highways within the respective Towns and Districts above mentioned do warn and call out the Inhabitants hereby made liable to work on the said Road to perform the Work and Labour hereby enjoined, and that every Person refusing or neglecting his Duty in the Premises shall be liable to the like Forfeitures as other Persons in like Cases are made liable to by this Act, to be sued for, recov-

ered, levied and applied as in such Cases respectively by this Act is declared and enacted.

*And be it further Enacted by the Authority aforesaid,* That the Work and Labour above directed to be done and performed on the Road leading from Brattleborough towards Albany, shall be done and performed on the same as it is now laid out, unless the same Road shall be altered by the Commissioners herein after named or any two of them. And that Samuel Anderson of the County of Albany and John Houghton and Malachi Church of the Township of Brattleborough in Cumberland County are hereby appointed Commissioners from Time to Time to inspect and view the said Road, and to make such Alterations in the Place or Places where the same is or shall be run or made, as they or any two of them shall think best, and most advantageous for the general Interest and Benefit of all the Inhabitants, each of which said Commissioners shall be, and hereby are entitled to the Sum of eight Shillings for each Day he or they shall be actually employed in the Service aforesaid; the Number of Days to be ascertained by the Oath of the said Commissioners respectively and the Sum which shall be due and owing to them and each of them respectively shall be raised levied and collected in the same Manner as the contingent Charges in the said Counties of Albany and Cumberland are directed to be raised and levied.

*And to prevent Idleness or Negligence which too frequently prevail in the Discharge or the necessary Services on the Highways, Be it Enacted by the Authority aforesaid,* That Eight Hours actual Labour and not less shall be computed and accepted for a Days Work and the Surveyors or Overseers of the Highways in each respective Township or District shall and are hereby respectively required to keep an Account according to the best of their Judgment of the Hours that each Person under their respective superintendence on whom the Duty of working on the Highways is enjoined, shall refuse or neglect to work of the Time required of him by this Act to work in each Day and for every such Hours Neglect or Refusal each such Person having been duly summoned shall forfeit the sum of one Shilling, to be levied by Distress and Sale of the Defaulters Goods and Chattels, which Distress and Sale shall be made by Warrant under the Hand and Seal of such Surveyor or Overseer of the Highways and directed to the nearest Constable, who is hereby required to execute the same and pay such Forfeiture to the Overseer who issued such Warrant.

*And* to facilitate the raising the County Charges in the said County of Cumberland, and more fully to carry into execution, the good Purposes intended by this Act, *Be it Enacted by the Authority aforesaid*, That in Case the Freeholders and Inhabitants of any Township or District in the said County shall neglect to elect and choose a Supervisor Assessors or Collectors or either of them at the Time or Times when the Same respectively ought to have been chosen in such Township or District; That the Justices of the Peace of the said County at their next Court of General Sessions of the Peace after such Neglect shall have happened, or the major Part of them at such Court are hereby authorized empowered and required from Time to Time under their Hands and Seals to nominate and appoint a Supervisor Assessors and Collectors or either of them that shall have been omitted to be chosen or refuse to act, in the Room and stead of such so omitted to be chosen or refusing to act, who shall be Supervisor or Assessors or Collectors according to his or their Appointment to all Intents and Purposes, with the like Powers and subject to the same Rules Pains Forfeitures and Penalties as any Supervisor Assessor or Collector chosen and elected by virtue of any of the Laws of this Colony; and any Assessor elected by the Freeholders or Inhabitants of any Township or District in the said County or so appointed as aforesaid by the said Justices at any Court of General Sessions of the Peace who shall refuse or neglect to do the Duty of his Office, shall be subject to the Penalty of ten Pounds to be sued for levied and recovered in like Manner as the other Penalties and Forfeitures mentioned in this Act, and directed to be sued for and recovered, and to be applied by order of the Court of General Sessions of the Peace to make mend or repair the Highways in the said County in such Place and Manner as the said Court of General Sessions of the Peace shall order and direct.

*And be it Enacted by the Authority aforesaid*, That the Supervisors of the said County of Cumberland shall meet annually at the County Town of the said County on the second Tuesday in June, and afterwards for that Year at such Time and Place as they or the major Part of them shall agree upon, and that the Supervisors so met at any one Meeting or a Majority of them shall and may proceed to fix the Proportion of the contingent Charges of the said County to be raised and levied in each Particular Township or District of the said County and to do all Matters and Things to be done by the Supervisors of the said County as fully and perfectly as if a Majority of all the Super-

visors of the said County were present any Law, Usage or Custom to the contrary notwithstanding.

*And be it Enacted by the Authority aforesaid*, That when and as often as any of the Penalties or Forfeitures of the Sum of ten Pounds each in this Act mentioned shall have accrued by reason of the Neglect or refusal of any Person or Persons to perform the Duty or Service on him or them thereby enjoined. And also, That when and as often as any Collector or shall by the Space of ten Days retain any Monies raised and levied or to be raised and levied by Tax on the Inhabitants of any Township or District in the said County of Cumberland having been first requested to pay the same to the Treasurer of the said County by the Sheriff of the said County or any one of his Deputies at the request of any Justice of the Peace in the said County, that each of the Sums so forfeited as aforesaid or any Sum or Sums of Money so detained by such Collector or Collectors as aforesaid shall be sued for and recovered with Costs of Suit by Action of Debt Bill Plaintiff Information or otherwise in the Inferior Court of Common Pleas of the said County, and in the Name of the County Treasurer of the said County for the Time being, who is hereby required and authorized to prosecute for the same, such Forfeiture or Forfeitures to be applied in such Place, and in such Manner as the Court of General Sessions of the Peace of the said County shall direct for the better laying out clearing and repairing the Public Highways of the said County, and such Sum or Sums of Money retained by any Collector or Collectors as aforesaid when recovered, to be applied for the use or uses for which the same were laid as a Tax or levied in the said County, and in any such Suit or Suits to be commenced by the Treasurer of the said County no Essoin Protection or Wager of Law, and no more than one Imparience shall be allowed. This Act to continue of force from the passing thereof until the first Day of March one thousand seven hundred and seventy seven.

## CHAPTER 1675.

[See chapter 924.]

An Act to amend an Act entitled "An Act to prevent Damages by Swine in the Manor of Livingston."

[Passed, March 9, 1774.]

WHEREAS the Act aforesaid, which was passed in the twenty sixth Year of the Reign of his late Majesty King George the

Sauthier's Map of 1779 shows the Albany Road running to Fort Massachusetts (Williamstown) and then continuing on an east-northeast course to Brattleboro. This map does not show the road running from Fort Massachusetts on a southeast course to Deerfield, even though the road would have existed at this time. [N.Y. State Library]

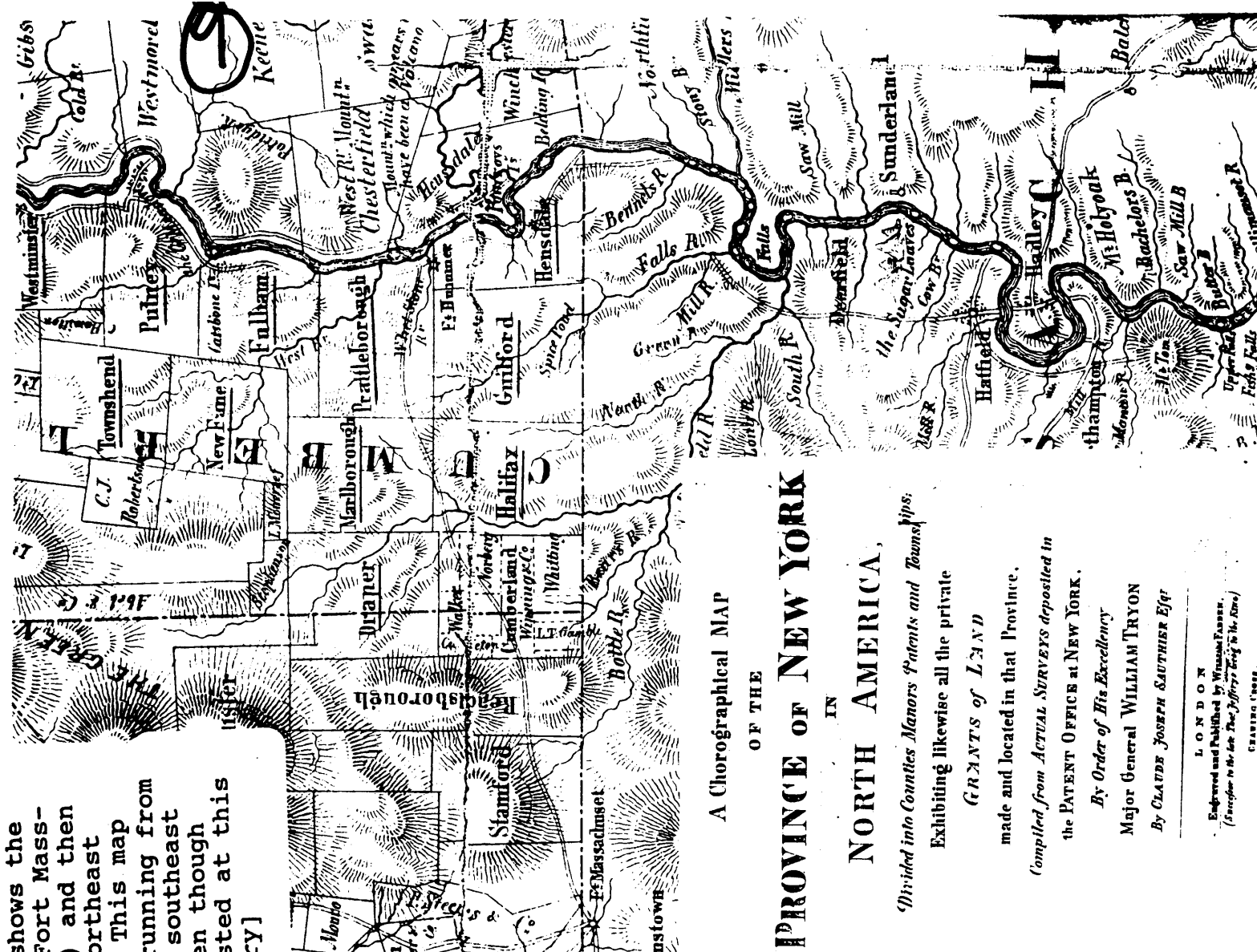
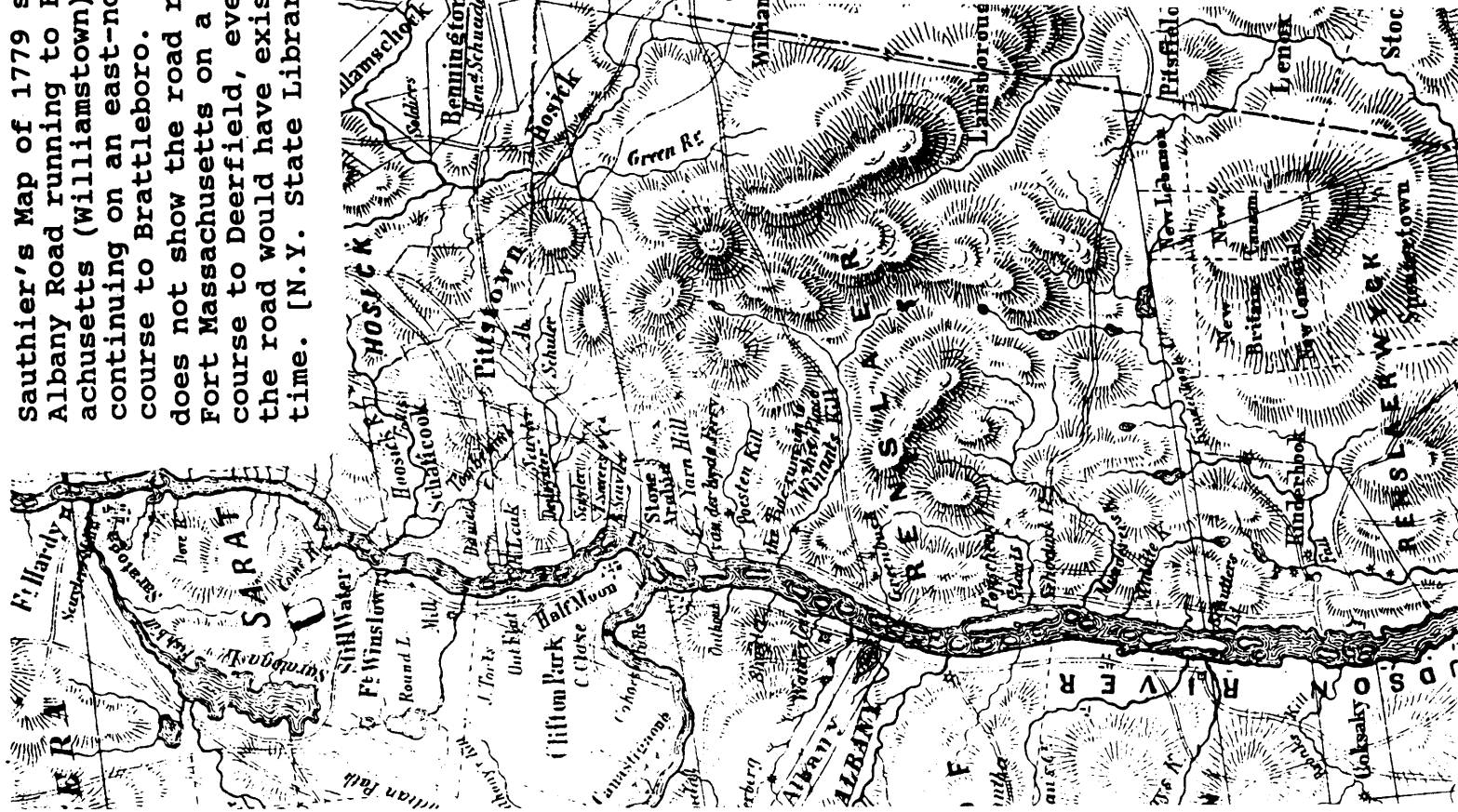

# A Chorographical MAP OF THE PROVINCE OF NEW YORK IN NORTH AMERICA,

*Divided into Counties Manors Patents and Townships;*

Exhibiting likewise all the private

GRANTS of LAND

made and located in that Province,

*(compiled from ACTUAL SURVEYS deposited in*

the PATENT OFFICE at NEW YORK,

*By Order of His Excellency*

Major General WILLIAM TRYON

*By CLAUDE JOSEPH SAUTHIER Esq<sup>r</sup>*

LONDON

Engraved and Published by WILKINS FENNER  
(Successor to the late Peter Jefferys Living in the Strand)

CLIPPING 1780.



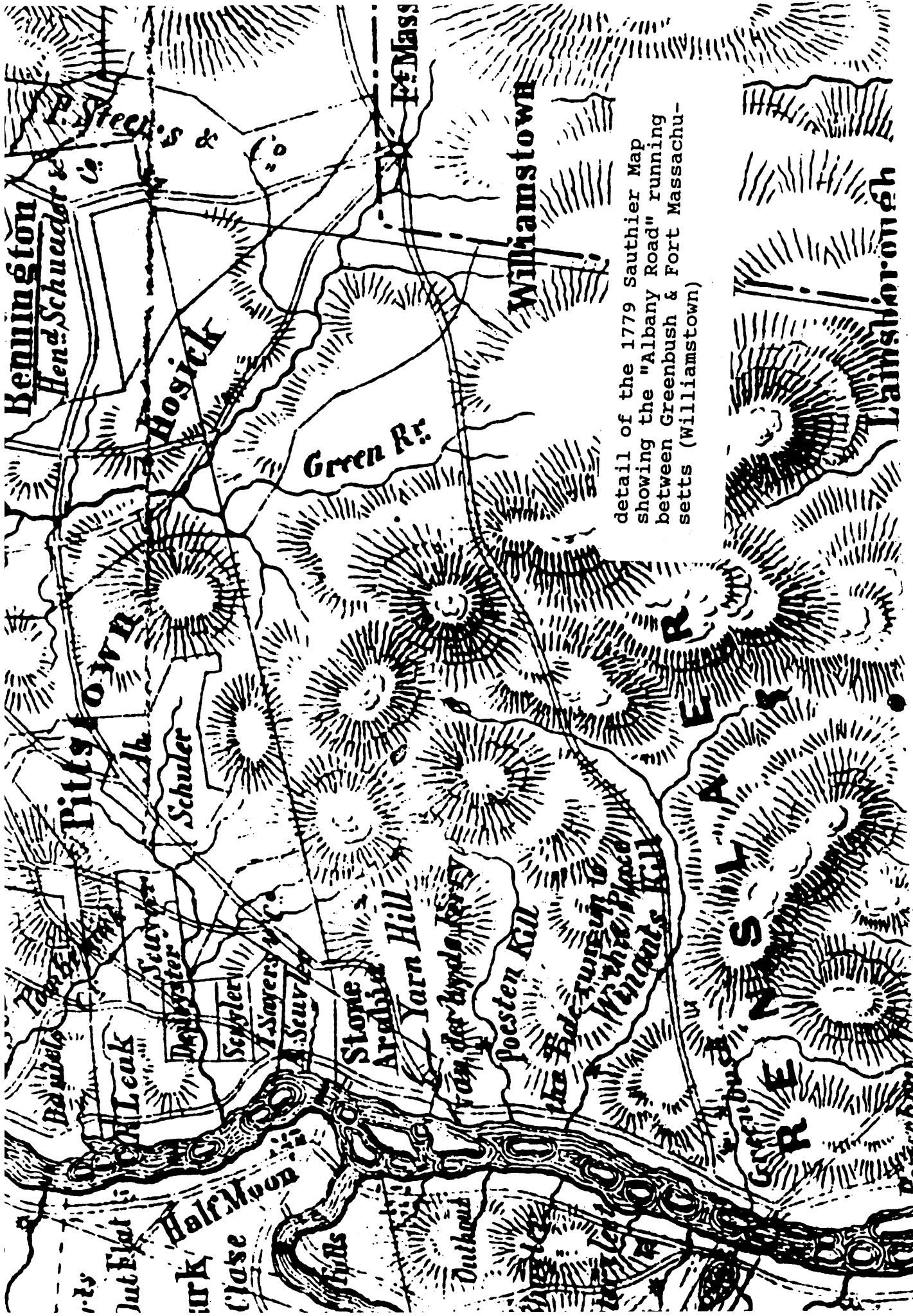

detail of the 1779 Sauthier Map  
showing the "Albany Road" running  
between Greenbush & Fort Massachu-  
setts (Williamstown)

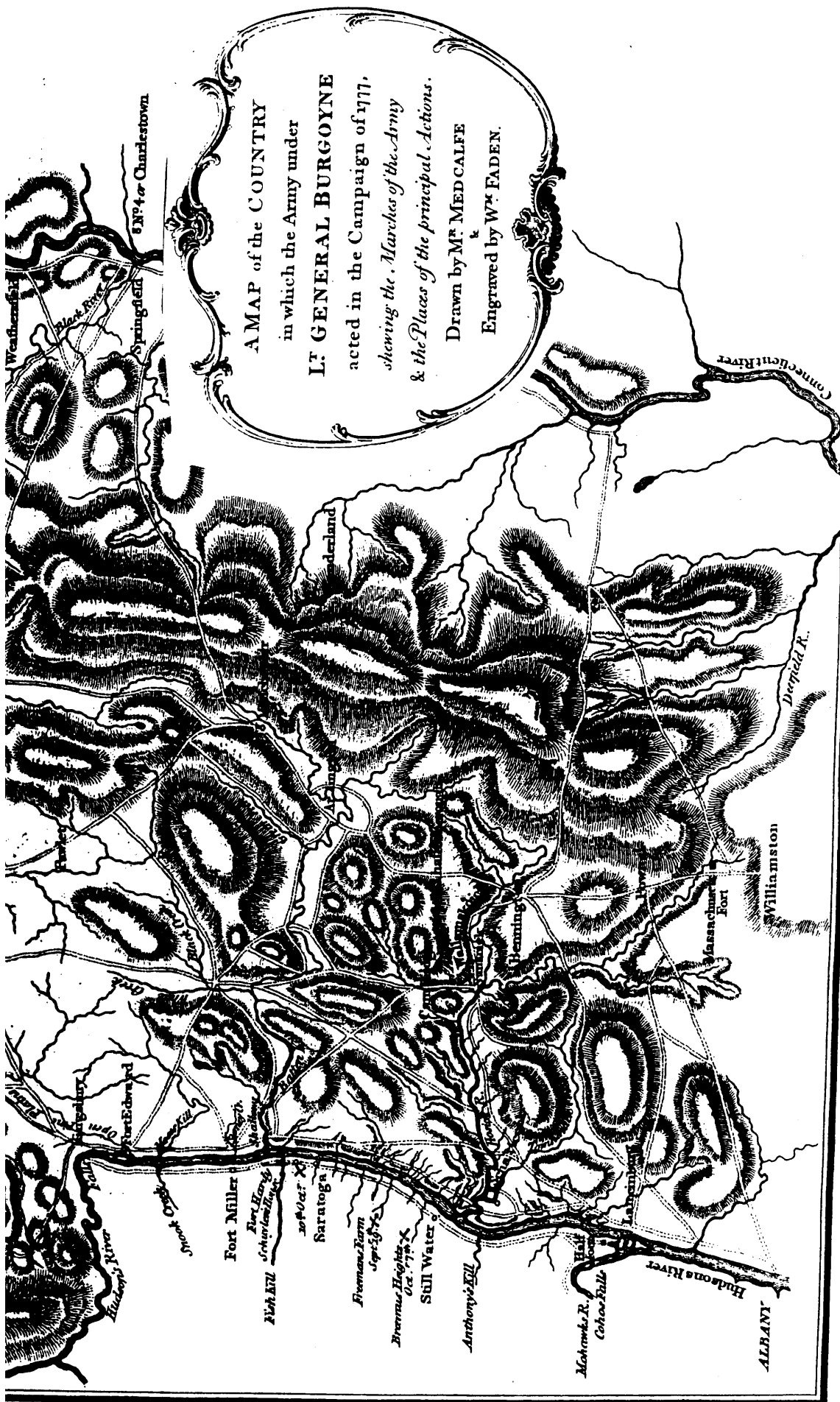

Medcalfe's Map of 1777-1780 shows the Albany Road running on a northeast course from Bath to just south of Pownal, & then on a southeast course to Fort Massachusetts. It shows a road running from the Fort on a northeast course to Brattleboro. It also shows the beginning of the road running on a southeast course to Deerfield from the fort. [New York State Library]

*London. Published as the Act directed, Feb. 1<sup>st</sup> 1780, by W<sup>m</sup> Faden, Charing Cross.*

[New York State Library]

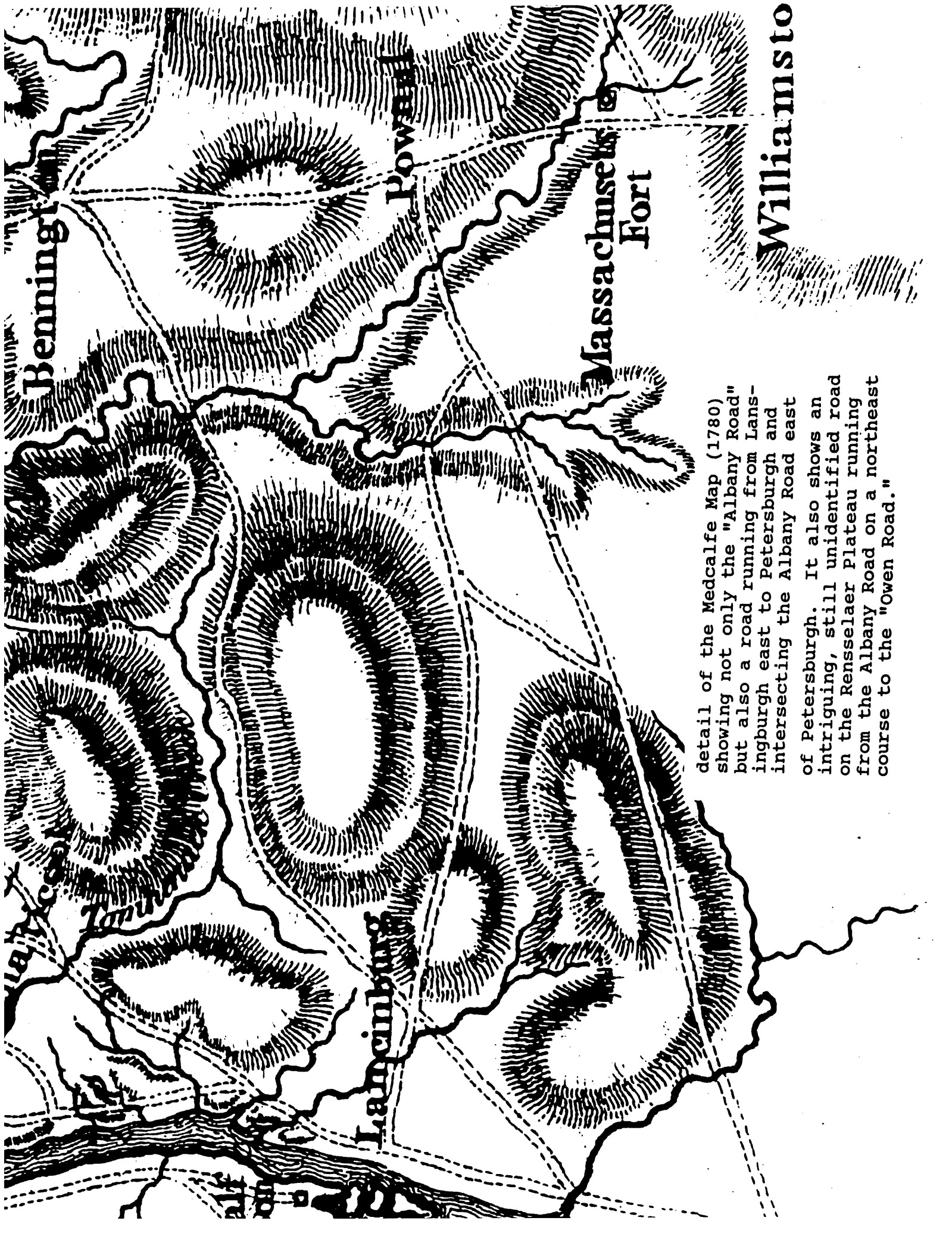

detail of the Medcalfe Map (1780) showing not only the "Albany Road" but also a road running from Lansingburgh east to Petersburg and intersecting the Albany Road east of Petersburg. It also shows an intriguing, still unidentified road on the Rensselaer Plateau running from the Albany Road on a northeast course to the "Owen Road."

Note the course of the Albany Road depicted by a dotted line crossing the wilderness in the present towns of Berlin and Poestenkill.

lots of undeveloped land in Berlin Sand Lake & Poestenkill, Rensselaer County, NY [from Map of Middletown by Job Gilbert (1788), New York State Library, Albany]

W. A. J. P.

071

MIDDLETOWN

TOWN

Manor

of

RENSSELAER

WYCK

Surveyed in the year

1788

By Job Gilbert

13



North Road 45.00 — or 5 1/2 Miles & 10.00<sup>at</sup>  
South — 37.00 — or 4 1/2 Miles & 8.00<sup>at</sup>

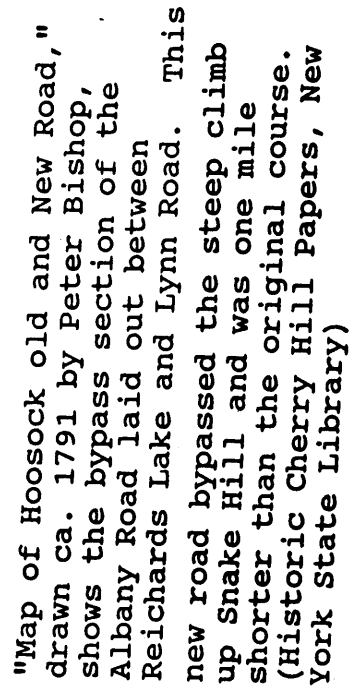

21

N<sup>o</sup> 91  
Beginning at Beech Tree No 75-90-91 being N.E. corner of Lot 70  
N 87 E 39.75 in line 75 to hemlock Stake No 75 876-91 892  
at 34.05 Crossed Hoosick Road  
S 18 W 40.00 in line of 92 to Spruce Stake No 91 92-107 & 108  
S 87 W 43.00 in line of 107 to hemlock Stake No 90 91 106 & 107  
N 18 E 40.00 in line of 90 to place of Beginning  
at 6.75 Crossed Hoosick Road A B N

Of May 6<sup>th</sup> 1841 offer to take containing 148.3.21  
Remarks from Judge Chas. Fox for & David  
Soil very uneven Cold and poor part Swamp  
Timber hemlock Spruce Fir some Beech possible Water  
Settled 1<sup>st</sup> 1841 conveyed by Deed to Francis of Albany consideration \$1500  
Leased to Joseph Perrigo Rent 9 Bu Wheat  
28<sup>th</sup> August 1793 -  
Sept 24<sup>th</sup> 1841 Jan 2<sup>nd</sup> 1842  
Nov 15<sup>th</sup> 1841 F. Severd April 1842  
Settled 1<sup>st</sup> 1841 John King others \$10.00 per Acre for Wood & Land

N<sup>o</sup> 92 Leased to Joseph Amidon for & Ruffshaw Baker  
for 10 years consideration \$300.  
Beginning at Hemlock Stake No 75-76-91 & 92 meaning 227 E 00 from  
Beech Tree No 75 & 91 being N.E. corner of Lot 70  
N 87 E 39.57 in line of 76 to Spruce Stake No 76-77 92 & 93  
at 16.37 Crossed Hoosick Road  
at 18.37 Crossed Large Brook Landing  
at 30.97 Small Brook  
S 18 W 40.00 in line of 93 to Spruce Stake No 92 93 106 & 107  
at 16.50 Crossed Large Brook Landing  
at 20.25 Crossed Hoosick Road  
S 87 W 39.98 in line of 108 to Spruce Stake No 91 92 107 & 108  
at 14.98 Small Brook Landing  
at 12.98 Small Brook  
N 18 E 40.00 in line of 91 to place of Beginning  
Settled 1<sup>st</sup> 1847 conveyed by Deed to Robert Powers  
to Robert Powers, John Burdett & contains 148.1.34

Remarks  
Soil Cold Stony and poor Hemlock Spruce  
Fir and some Beech Well Watered

Leased to Christopher Coats March 24 1794  
Settled 1<sup>st</sup> 1847 conveyed by Deed to Robert Powers P.B. 41

Rec-Entry made for Lease  
1824  
Jan 1

Rec-Entry made for Lease  
1824  
Jan 1

~~Patron~~ ~~Van Rensselaer Esq~~ : Sir we would inform your  
Honor that there is William King and William Butts <sup>Jun</sup> ~~would~~  
wish to make Application to you for to get a certain Lot  
of Land and we Recommend the young Men to you to be  
very Honest and Industrious and good inhabitants in the  
Neighborhood they Reside in, and would wish to be Tenants  
under your Lordship & Humble Servant  
Martin Smith

To Mr Van Rensselaer Esq, Stephen Hull  
Samuel Hammett

The Number of the above Lot 103.

William King & William Butts to have the Lease of this Lot at 12 Bushels of Rye per Acre  
first Rent to be paid Jan'y 1806 -  
Decr 29<sup>th</sup> 1804 -

William King & William Butts sub-  
mitted this "character reference"  
to the Patroon in their application  
for a lease for Lot No. 103 in  
Middletown in 1804. Lot 103 was  
traversed by the Albany Road and  
included the northwest part of  
Hicks Pond. (Van Rensselaer Manor  
Papers, New York State Library)

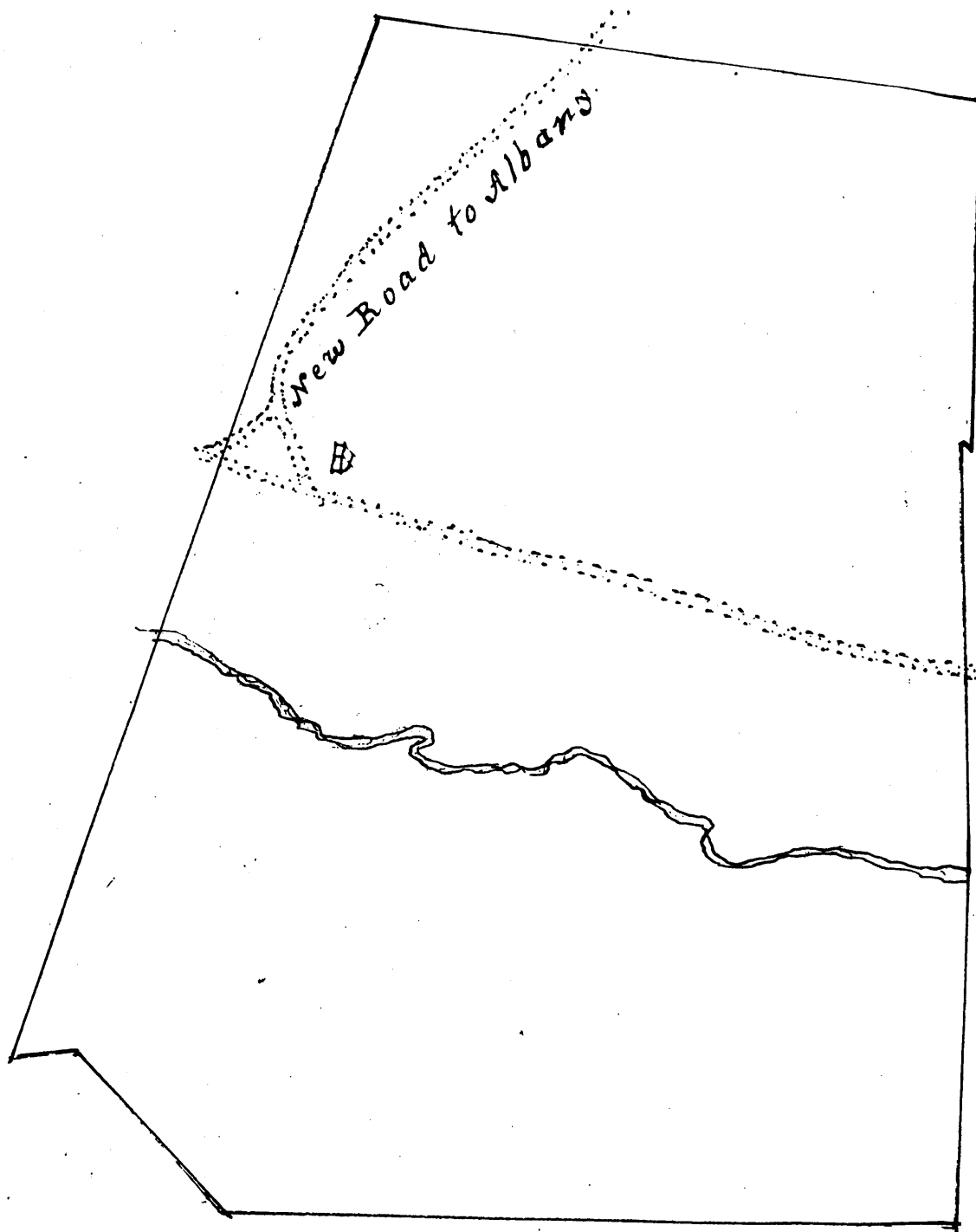

survey map for lot leased to John Barber Babcock in "Little Hoosick" showing the Sedgwick Inn. Lower Stage Coach Road is referred to as "New Road to Albany" while Route 22 is referred to in these surveys as the "Great Road." The Little Hoosic River also shows in this map.  
[Van Rensselaer Manor Papers, New York State Library]



. . . brook on which the Grist Mill  
of said Cross now stands, then down  
the said brook . . . to the south  
side of the Albany Road . . .  
[from Little Hoosick Survey, 1790]

## WILLIAM CROSS

drawn

Begins at a marked Hazel Maple tree standing in the West line of the Town  
Surveys for Robert Perigo and at the South side of the brook coming out  
of the Pond commonly called Kendaal's Pond, and runs from thence to the

1. S. 20° 30' W. -- 2.30 to a black Stake Johnas thence

2. Due South 57.67. to a small Spruce tree marked W.C. thence

3. S. 47° W. -- 10.60 to marked Spruce Sapling thence

4. N. 01° W. -- 10.85 to a Spruce stake Johnas thence

5. N. 63° 30' W. 20.1 - to a Spruce Sapling standing at the South side of the brook  
on which the Grist Mill of the said Johnas now stands.  
Thence down the said brook at it winds and turns to a Stake  
Johnas at the South side of the Albany Road and at the distance  
of 26.70 on a straight line from the said Spruce Sapling thence

6. N. 25° E. -- 15.10 to a marked hemlock tree thence

7. N. 70° E. -- 7.20 to a Spruce Stake Johnas thence

8. Due North -- 15.76 to a Spruce Stake Johnas thence

9. N. 32° W. -- 6.70 to a marked Spruce Sapling Johnas at the East side of the  
beforementioned Kendaal's Pond thence along the same to  
where the beforementioned brook comes out of the said  
Pond and thence down the same as it winds and  
turns to the place of beginning for tenths 102, Acres

25  
Renda's  
Pond

Grout Mill

Croß

Albany Road

survey map showing lots of land in  
the Town of Berlin, Rensselaer  
County, New York, ca. 1790  
[Van Rensselaer Manor papers, New  
York State Library, Albany]

"survey bill" for Jonathan Green's farm in Green Hollow in Berlin. His farm was the easternmost on the "Albany Road" before the road climbed Berlin Pass. The house

shown on the survey map stands today on Canfield Road. The "Albany Road" is merely labelled "highway" on the survey map. (VR Manor Papers, NY State Library)

Survey bill made for Jonathan Green Lying Abaught Three Quarter of one

mils East from Capt. Hughes house  
Beginning at the N<sup>th</sup> & Corner  
Stake and Stone Standing at the  
Foot of a Steep Bank It being  
N 61° W from Moses Allen House  
and Standing in said Allen Line  
then turn N 83° W 30  
then N 60° W 7 = 00  
then N 15° W 19 = 25 to a sharp W bend Stone  
then N 75° W 18 = 50 to a marked bush line  
then S 9° E 27 = 50 to Stake and Stone  
then S 9° W 20 = 00 to the Road  
then S 16° W 31 = 60 to a bush Sapling  
marked from Side  
then S 71° E 15 = 00 to an Iron Wood Sapling  
then N 21° E 50 = 80 to the Place  
of Beginning

Containing 133 acres &

29 Acres Deduction for Road.

one acre and 3/4 duties

remains 31 = 1 = 29

Asst. H. H. Hull

house

highway

About Eighty acres feasible Land  
and the Cliff Mountain

August 24<sup>th</sup> 1789

There appears to be no  
Dipgate

Asst. H. H. Hull

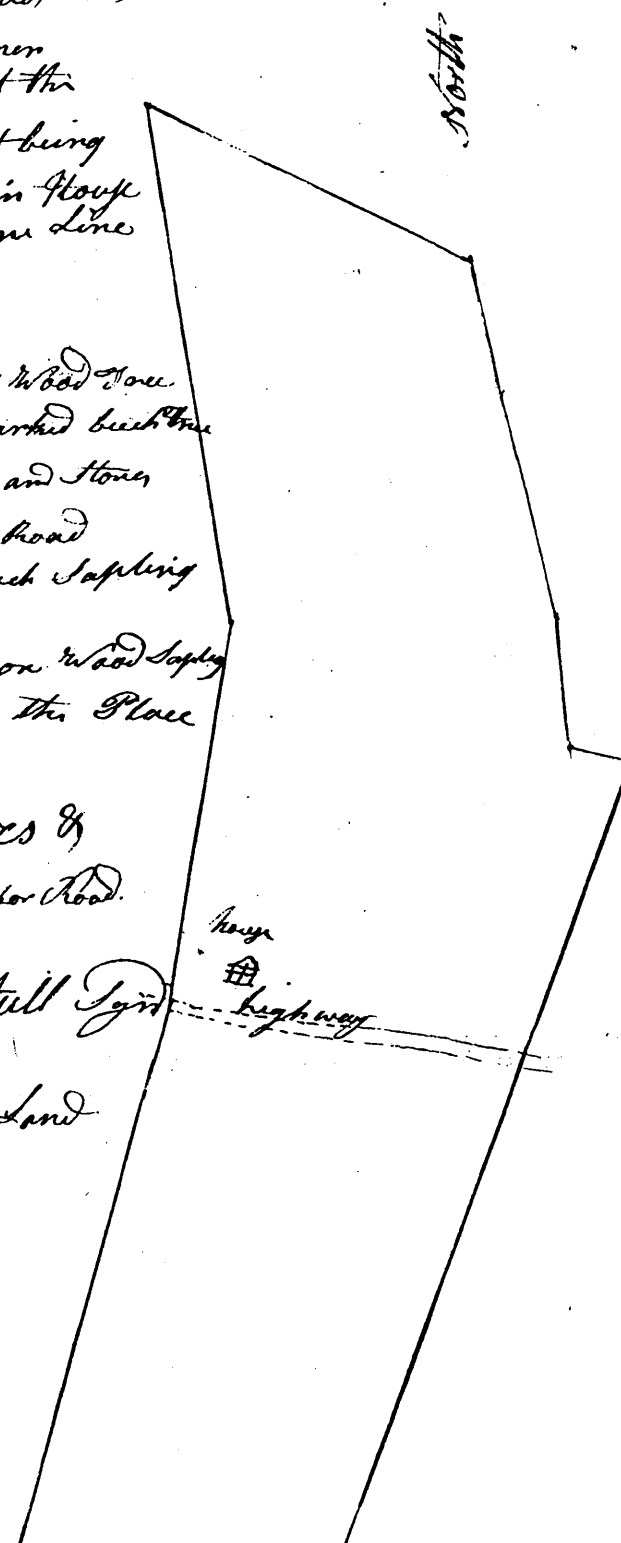

[illegible]

14

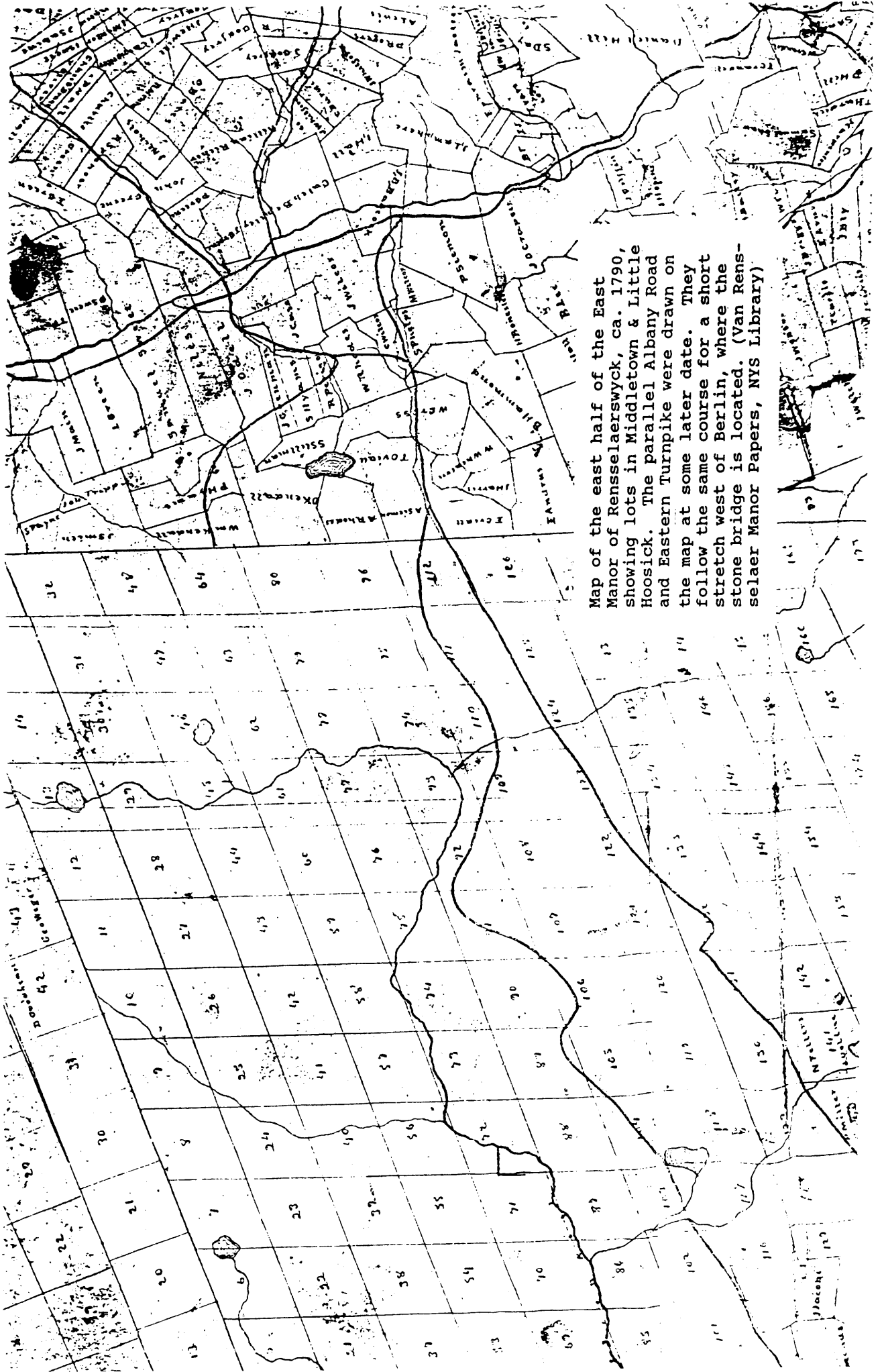

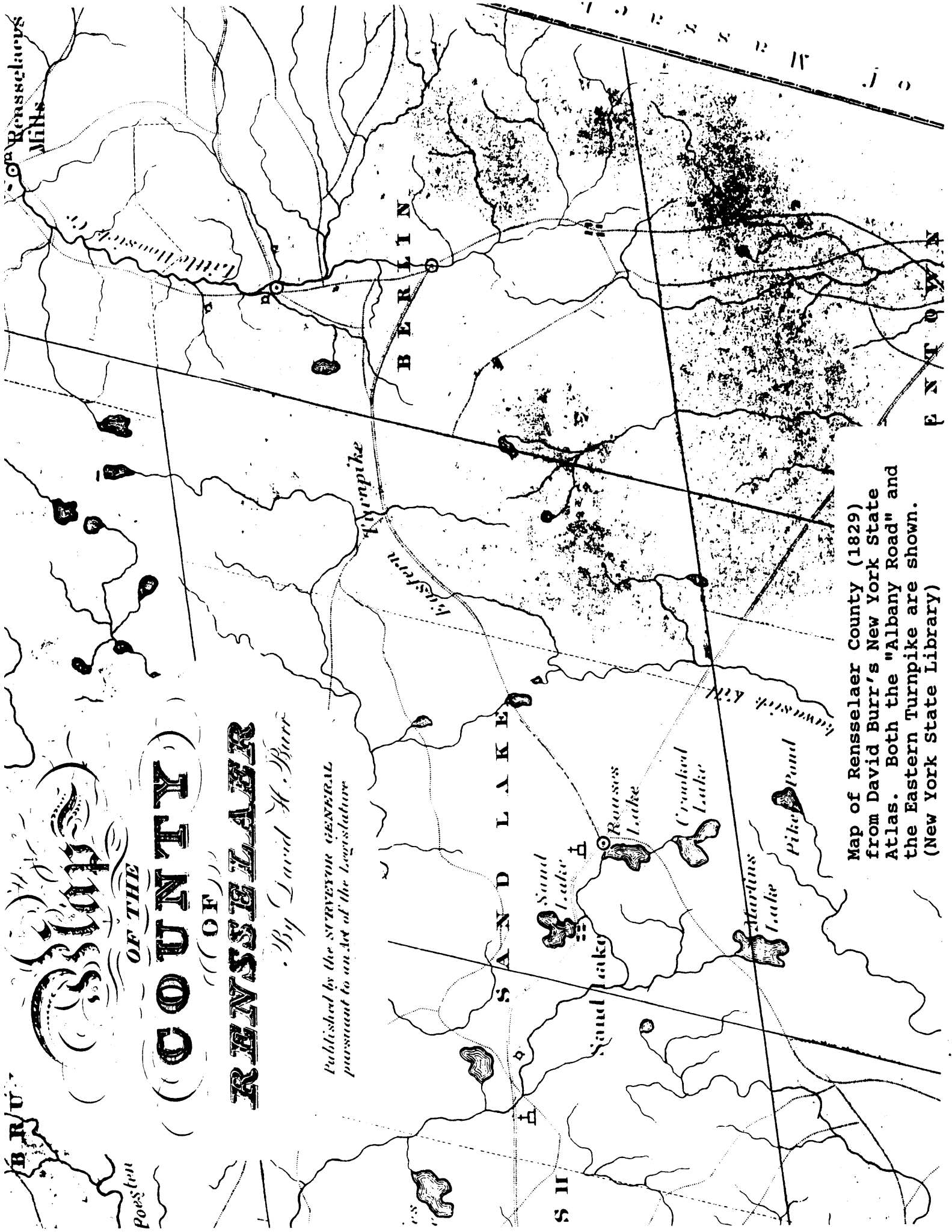

BRU  
Posten

**Map**  
**OF THE**  
**COUNTY**  
**OF**  
**RENSSELAER**

By David H. Burr

Published by the SURVEYOR GENERAL  
pursuant to an Act of the Legislature

Map of Rensselaer County (1829)  
from David Burr's New York State  
Atlas. Both the "Albany Road" and  
the Eastern Turnpike are shown.  
(New York State Library)

15

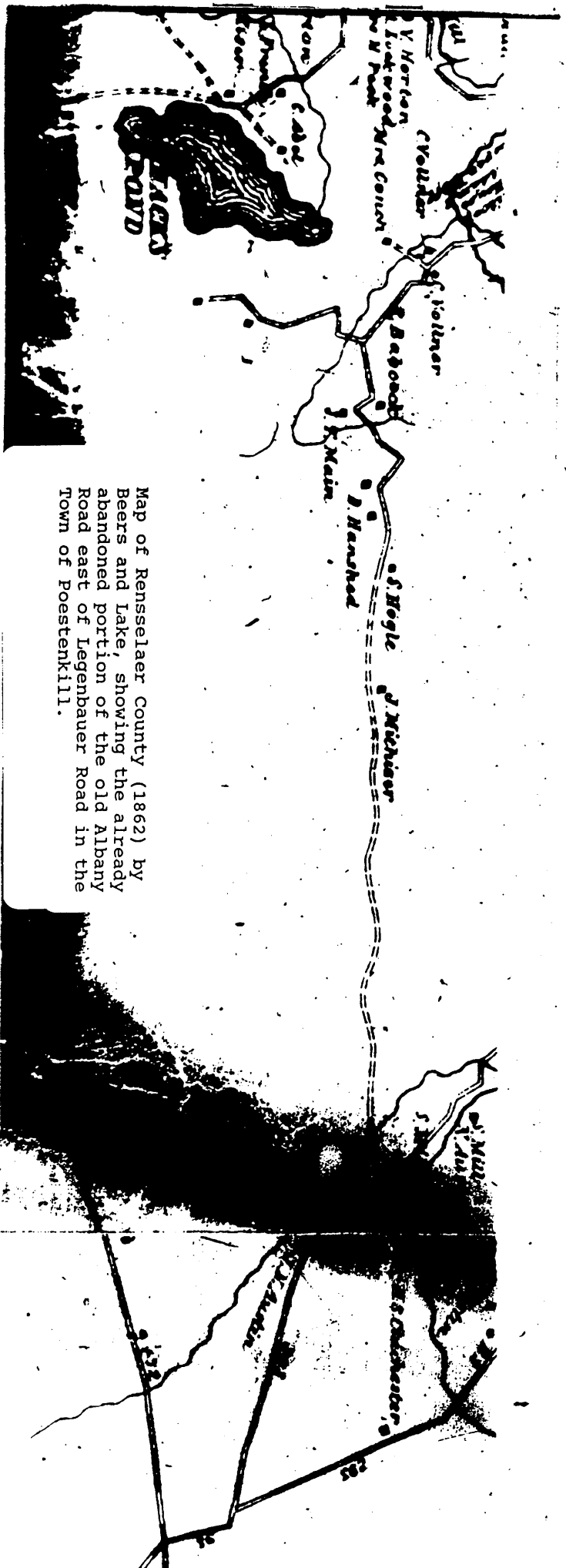





(16)

Map of Rensselaer County (1862) by Beers and Lake, showing the Albany Road and Eastern Turnpike west of Berlin. The Albany Road was not in use west of the Wheeler tavern.

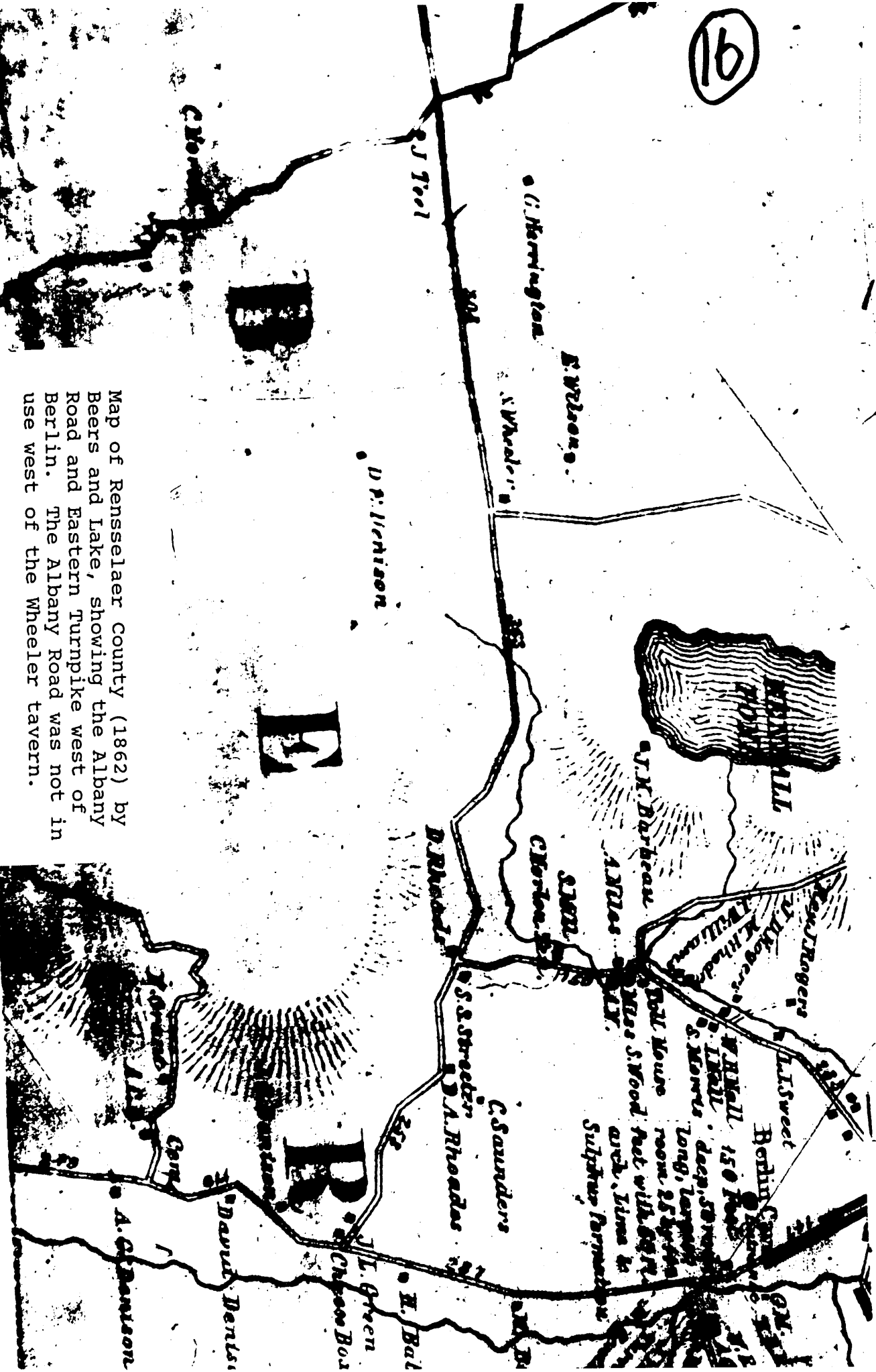

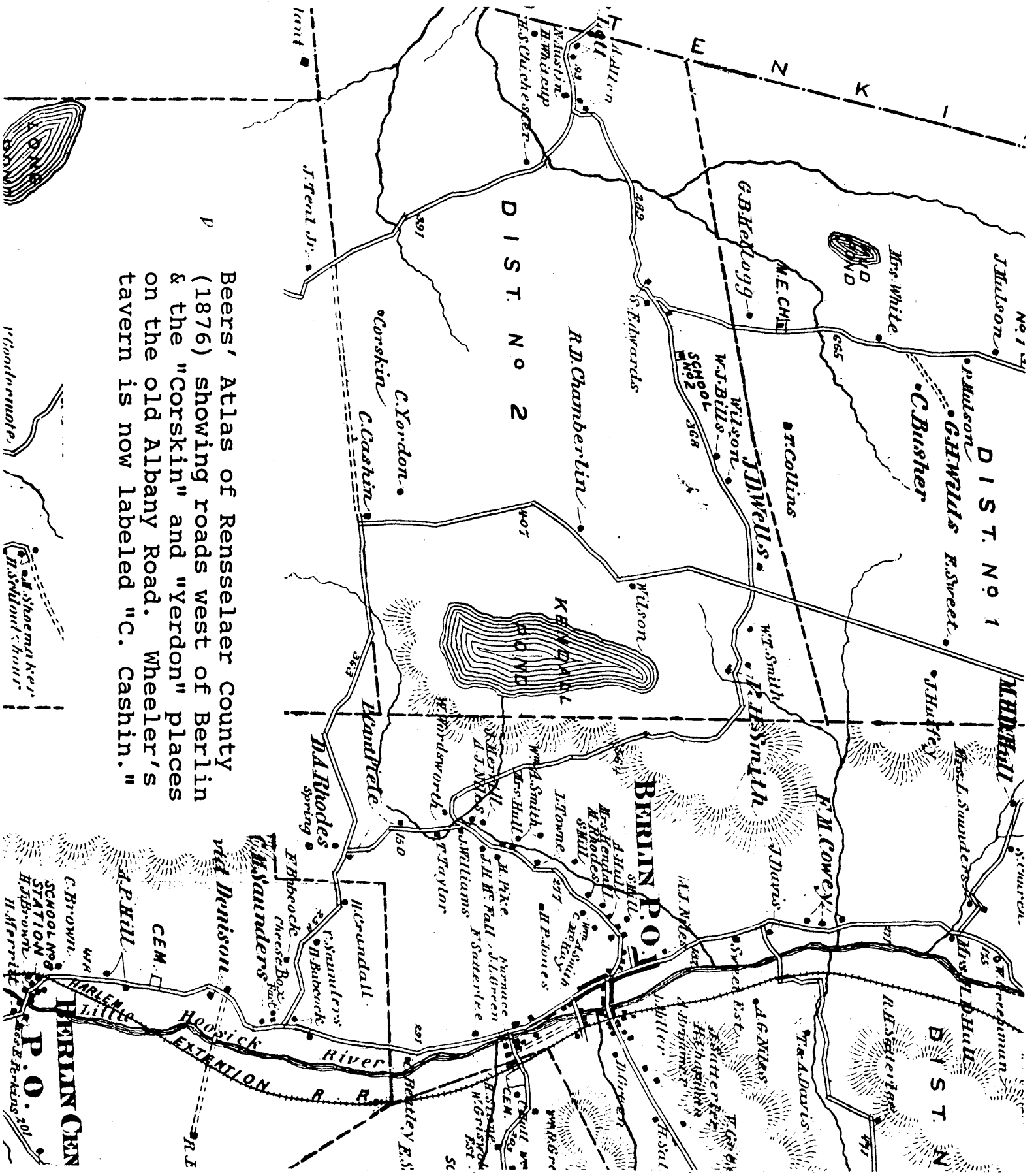

Beers' Atlas of Rensselaer County (1876) showing roads west of Berlin & the "Corskin" and "Yordon" places on the old Albany Road. Wheeler's tavern is now labeled "C. Cashin."

Wooden water

Shoemaker's house

BERLIN CEN  
STATION  
P.O.  
H. Brown  
H. Brown  
H. Brown

17

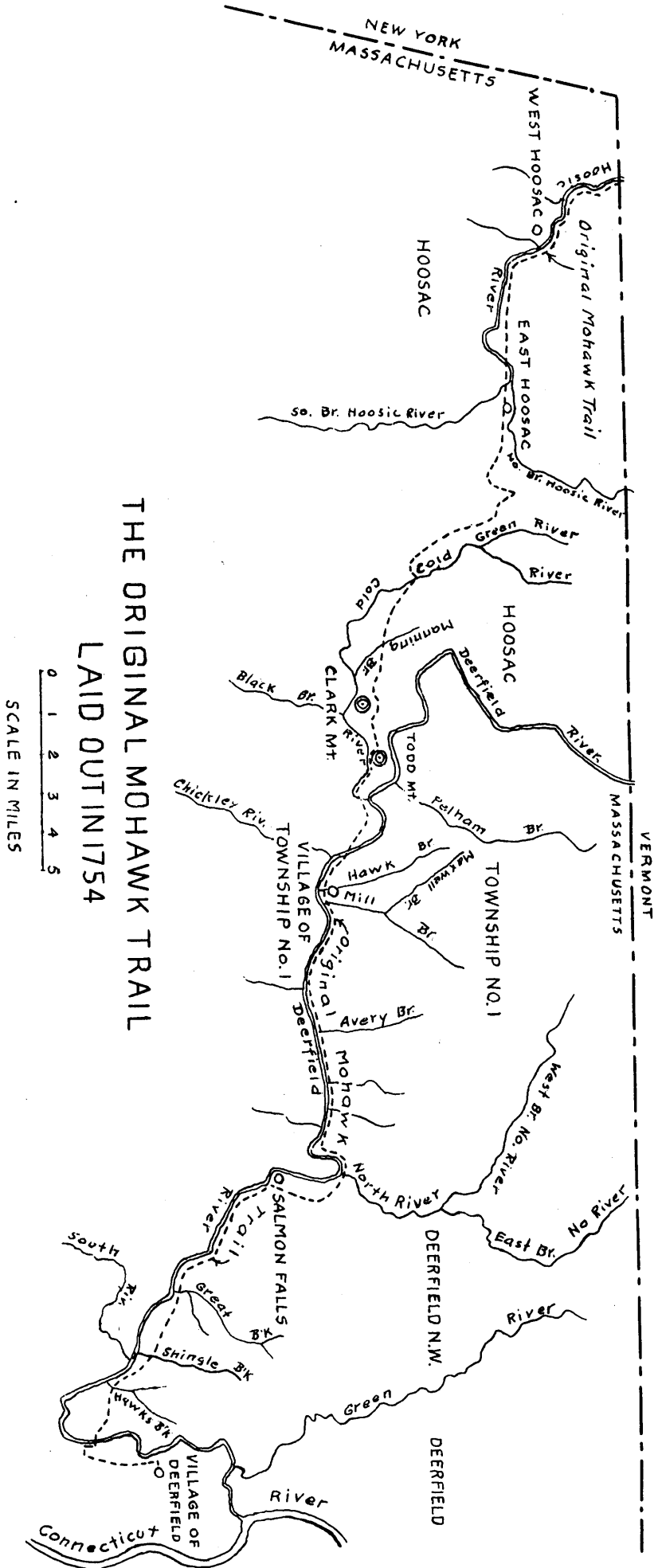

Map drawn by David L. Costello,  
showing the course of the first  
"Albany Road" of 1754 between  
Deerfield and West Hoosac  
(Williamstown.)

section of one of the "Costello Maps," showing various courses of the "Albany Road" as it climbed Hoosic Mountain from the east.  
(Historic Deerfield Library)

